

County Surveyor's Record, Douglas County, Oregon

Survey No.

Made for... Warren P. Reed

T 21 S., R 12 W.

Field notes of this survey of the tide lands of section 22 - Tp. 21 S., R. 12 W., Willamette Meridian, situated in Douglas County, State of Oregon. Beginning at a point 28.67 chs. South and 12.99 chains East from the meander post on line between sections 15 and 22. and running thence S. 55° E along dyke 2.00 chs S. 17° E. 9.00th to South line of Reed's land and north line of G. M. Co. West. 50 chs. to low water mark. N 23° W. 10.50 chs along low water mark. East 0.25 chs to place of beginning containing 1.06 acres.

I, W. H. Byars, Deputy County Surveyor of Douglas County do hereby certify that on the 24th day of September 1902 at the request of Warren P. Reed I surveyed the tide lands above described of Section 22 Tp 21 S., R 12 W.; that the foregoing are true and correct returns of said survey, and that the attached map of the lands applied for is accurate, showing the courses and distances of the boundary line and a correct calculation of the area thereof, that all the lands embraced in said survey are tide lands, and that said survey includes all of the tide lands in front of Reed's land here represented and I value the same at \$2.00 per acre.

W. H. Byars, Deputy County Surveyor of Douglas

State of Oregon } 32
County of Douglas }

Subscribed and sworn to before me this 27 day of Sept 1902

Geo E. Lyster

Notary Public for Oregon

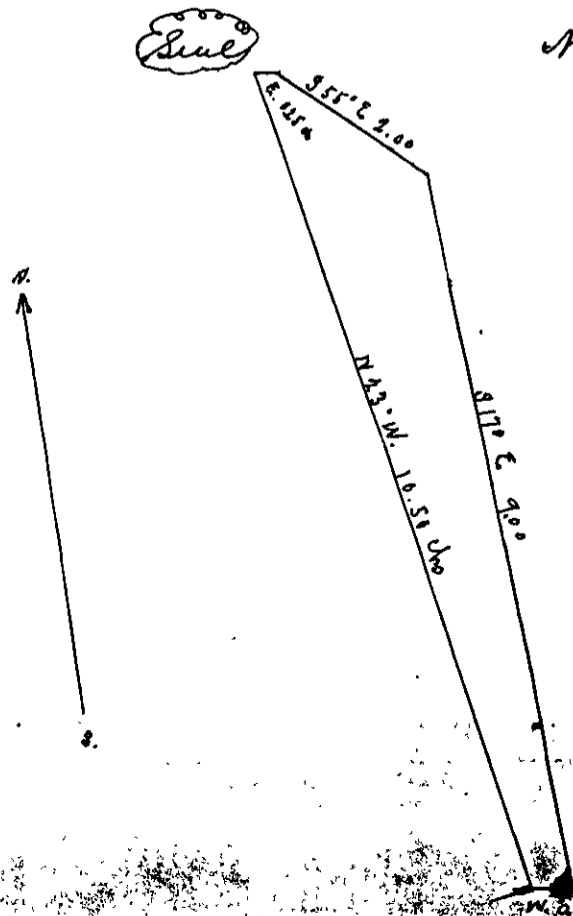

Recorded by C. E. Robert
Co. Surveyor.