

Survey No. ....

Made for *A. E. Clayton and Henry Paulsen*

Sept. 16. 1912  
T. 26 S. R. 7 W.  
T. 25 S. R. 7 W.

This survey was made to divide the Ashford Clayton D.C. into two equal parts by running an East and West line through same said D.C. lying in Secs 2 and 3 T 26-7 and Secs. 34 and 35 T 25-7. I located the sec. cor. common to Secs. 2 and 3 and 34 and 35 from the witness trees which are all standing and set a post-marked C.S. at intersection of courses from bearing trees as per field notes. Thence North <sup>(bear. 19°45' E)</sup> for a point 3.50 chs. Through this point I ran an East and West line to intersect the East and West boundaries of the Claim which are well defined

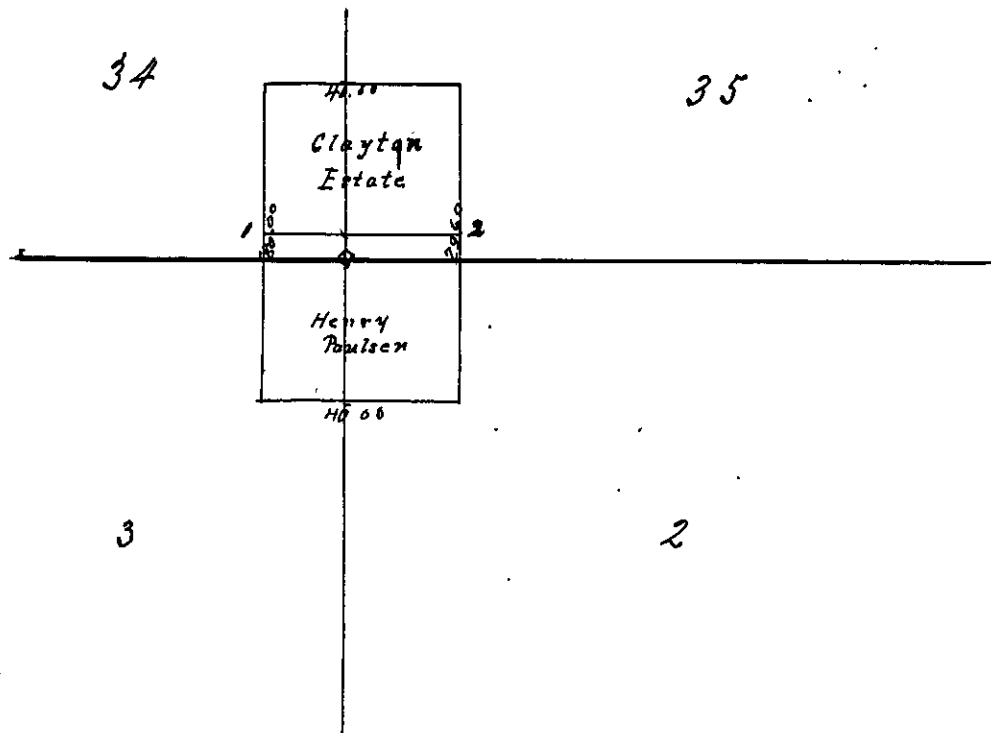

Witnesses to corners as per plat

- 1. white oak 10" N 58° 30' E. 50 lks.
- 2. " " 12" N 62° - W. 42 "

*C. E. Roberts,*  
Co. Surveyor