

County Surveyor's Record, Douglas County, Oregon

Survey No.

Made for

T. 28. S. R. 6 W
 SURVEY No. 6
 20

Fr. Waite and Meller. Febr 18. 1899.

Set cor of sec 20, 21, 22 and 23, thence run North, Var 20°10' E, at 20 chs ~~set mark~~ ^{set} a wh. oak 3" dia post for cor, from which a wh oak 3" dia bears E, 2 lks dist, a wh oak 3" diam bears W. 7 lks dist Thence I run S 89°55' E 20.15 chns, set a post, from which a bl. oak 26" dia bears N 1 1/2° E 50 lks dist, a bl. oak 24" dia bears N. 35 1/2° W. 79 lks dist

SURVEY No. 7

Henry Easton. Febr. 20. 1899. City of Roseburg.

I could find no mark, designating the proper place, on the monument for initial point of survey for Roseburg, the same having been destroyed, by wagons passing over it and wearing the mark away. It being a case of inches, and the party drunk, I quit

SURVEY No. 8

Robert B. Ester Febr 21. 1899.

Begin on N.W. cor. of R. Reed donation, run thence S 74° W Var 20°35' E to intersection with the West boundary of land; thence S 13 1/2° E. 34 chs, to Calaproya, thence up stream opposite to a line and fence This survey was subsequently done away and changed by the parties.

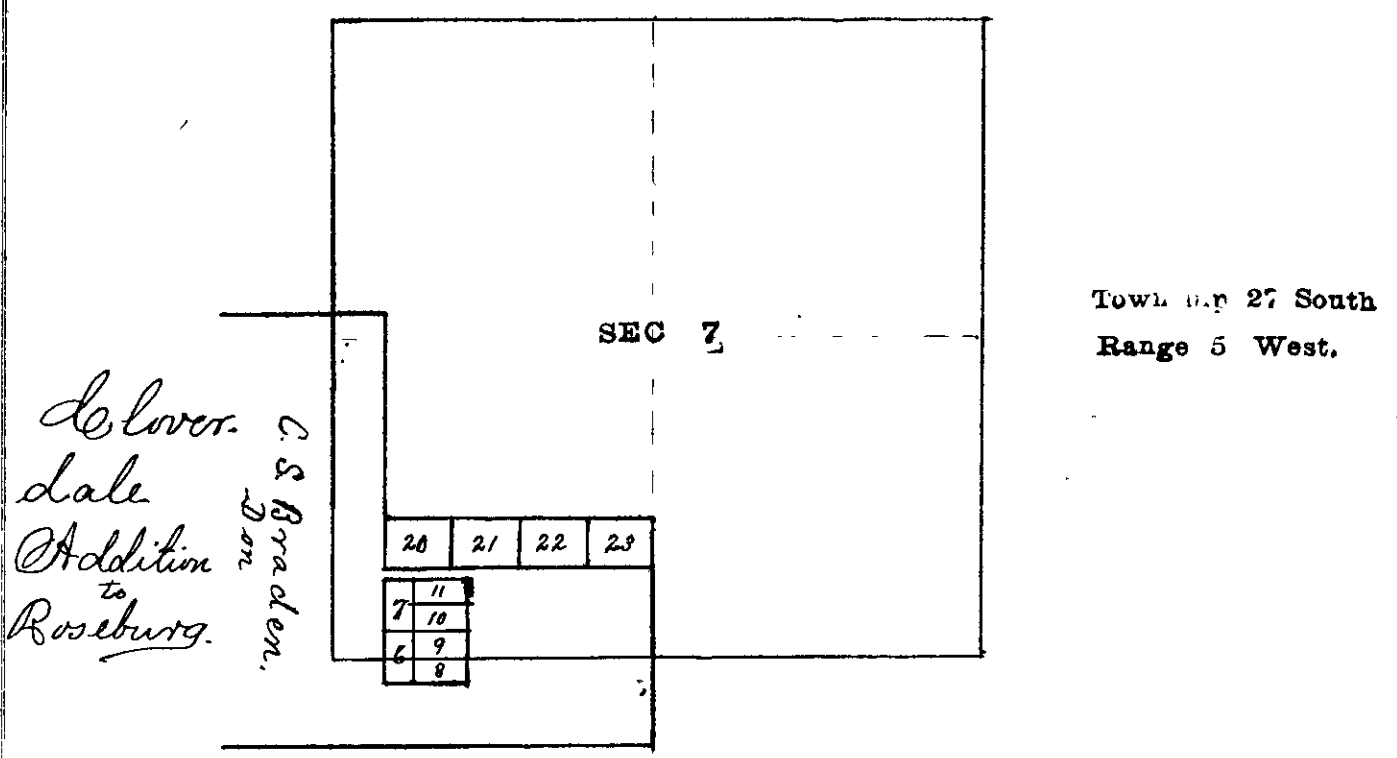

Mar. 6th 1899.

SURVEY No. 9
 FC 113 Pg 6-7

Martin Butler

Begin at the L cor of the C. S. Braden donation. Claim and run E 33.10 chns to NE cor of claim, along on N line of lots No. 20, 21, 22 & 23; thence S 5.84 chns, thence West 23.13 chns thence South 14.37 chns, thence West 9.97 chns. thence North to place of beginning

Mar. 8 & 9 1899.

SURVEY No. 10.
 FC 113 Pg 8

James Richard

Beginning at a point 18.07 chns North of the NW. Cor. of the J. N. Smith donation claim, and 7.34 chns S of the NE cor of the D. Hurst donation claim, thence S 83° W. 21.03 chns. along county road; thence N 19° W. 10.53 chns. to North line of Hurst claim; thence N. 14° W.