

County Surveyor's Record, Douglas County, Oregon

Survey No. 20

Made for John Watson & others

Jan 15th + 15th
T. 26 S. R. 3 W.

For the purpose of ascertaining the amount of lands belonging to Monroe Whittow & Whittow & to establish the line between said Whittows & J. L. Watson in the N.E. qr of section 34 Town 26 S. R. 3. W. N.W. m I begin at the N.E. Corner of said section & run South Va. 20° E. 40 chains & set the gr Post from the stumps of the original witness trees & also make new witness trees to gr Post To Mill a N. 0. 20° dia bears S. 11° E. 65 links an ash 16" dia bears N 12° 30' W 55 links I now run ~~East~~ ^{west} Through the center of section 34. at 40 chains set temporary stake for center of section at 80 chains I intersect 11 links north of the gr Post on West side of section the original B. J. still standing & now return to center of section & set temporary post 5 1/2 links South thence North 40 chains to the gr Post on the N side of section at 20 chains & set the S.W. corner of the N.W. 1/4 of the Cedar 20" bears S 67° W 6.28 links N.E. corner thence East 18.66 links set W.C. on the Right bank of the East fork of the Umpqua river from which a fir 10" dia S. 55° W - 56 links 20 chain to corner in river I now return to gr Post on E side of section & at 20 chains set S.W. corner of N.W. 1/4 of N.E. 1/4 a stone from which a pine 12" dia S. 39° E. 52 links distant thence N. 18.33 a N.C. stump I make for the W.C. on Right bank of River from which a fir 20" dia bears N 86° E. 12.91 40 chains to corner in river Monroe Whittow & J. H. Morgan, chairman by agreement of Parties

T. 26 S. R. 3. W

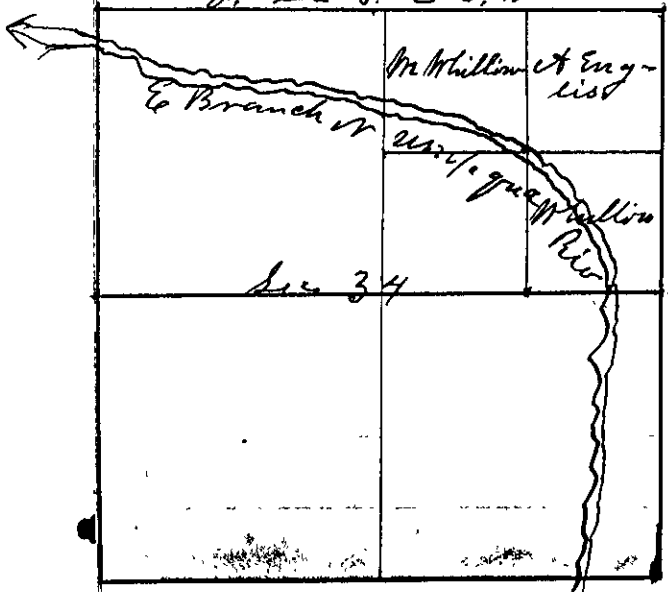

Will P. Heydon Co Sur