

Survey No. 18

Made for D. D. Levens

Weston Dyck Book Mfg. Co., Portland, Or. - 2844

Oct 13 - 1893
T. 30 S. R. 5 W.

See Albrough & Norman Albrough Survey chainmen
Beginning at corner to Secs 21, 22, 27 & 28, T. 30 S. R. 5 W. 7th Mer
Bear 19° E.

Thence South 21.93 ch to a rock cor - from which
Laurel 8 in dia bears S 74° E. 114 links marked C.S. B.T.

Bear 21 1/2° E.

Thence East 23.38 ch to post in county (marked C.S. from
Pine 12 in dia bears N 21° W. 147 links marked C.S. B.T.

Thence ^{N 19° E} N 11 1/2° W 5.23 ch. Thence N 29° W 9.39 ch

Thence N 45° W 11.15 ch. Thence N 83 1/2° W 6.06 ch and

Thence N 87° W 3.60 ch to place of beginning Cont 39 25/100 as

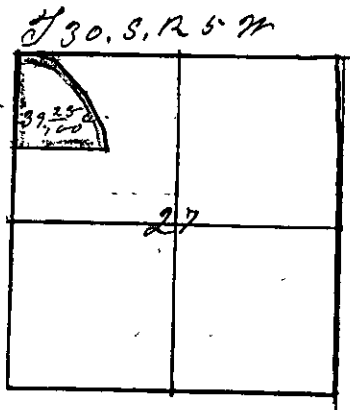

W. J. Briggs
Co Sur

Survey No 19

John W. Brown

Oct 17 1893
T. 25 S. R. 5 W.

For the purpose of finding the location of Block
Number 5 of Brown Addition to the town of
Perkance Oregon.

Beginning at quarter post on north boundary of
Sec 4, T. 25 S. R. 5 W. 7th Mer. - Bear 19 1/2° E.

Thence South 12 rods to the N.W. cor of Brown
addition Thence South 616 feet to the N.W.
corner of "B" 5. Thence East 256 feet. Thence
South 240 feet. Thence West 256 feet. and
Thence North 240 feet. to starting point of Sec.
of "B" 5.

W. J. Briggs
Co Sur