

Survey No. 10

Made for John & Geo. W. Kerns

Aug 15th 1894
T. 27 S. R. 5 W.

Beginning at the N. E. Corner of Claim No 46. & S. E. Corner of Claim No 45 in Section 21, T 27 S R 5 W. N. M. These Original Witness were badly decayed scarcely discernible. Made new Witness tree to wit:

B Oak 12 in dia bears West 16 links marked C 46 C.S. B.T.

B " 12 " " N 12° W. 10 " " C 45 C.S. B.T.

Set post 4 in square 24 in in the ground 24 in above ground

marked C. 46 C.S. facing S. E. & C. 45 C.S. facing S. W.

Bar 1855-8

Thence West 25.32 ch set post marked C 46 C.S.

The Original witness has been destroyed made new B.T.

An Oak 6 in dia bears S 2° W. 136 links marked C 46 C.S. B.T.

Thence 14.52 ch set post marked C.S. - from which

W Oak 8 in dia bears N 38° E. 102 links - marked C.S. B.T.

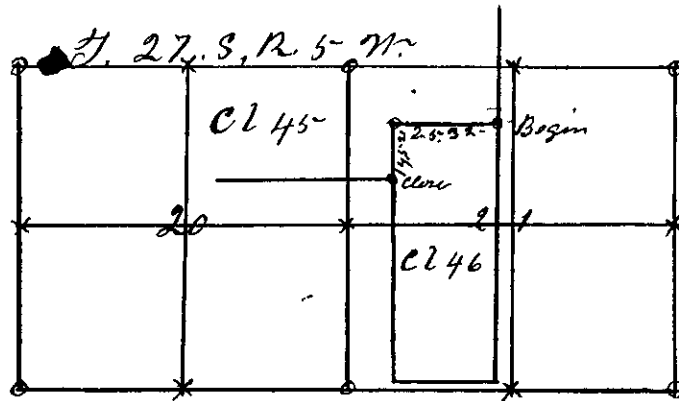

W. H. Briggs

Co Sur

Aug 25th
T. 27 S. R. 7 W.

Survey No 11

O. H. Buell.

Beginning at the N. W. corner of C. L. No 38.

T 27. S. R. 7 W. N. M. Oregon - - - Bar 1930' 6

Thence set post marked C. L. 38. C.S. as per original.

Witness tree still standing to wit:

W. Oak 24 in dia bears N 72 1/2° W. 224 links marked C 288

C.S. B.T.

Thence East 26.00 ch set post marked C.S. - from which

W Oak 6 in dia bears S 17 1/4° W. 34 links marked C.S. B.T.

Thence South on sight - line to creek.

W. H. Briggs

Co Sur