

No. 48

Field notes of a line run between Daniel Bollenbough and J. W. How on the 28<sup>th</sup> day of April A. D. 1874. Camdenville Precinct Douglas County State of Oregon

Beginning at Quarter post bet Secs 32 & 33, T. 30 S. R. 5 W. from which

A Laurel 12 in dia at 25° W. 42 lbs  
 " 8 " " S 10° E. 29 "

Thence as follows

Near 19° 20' E.

S 89° 43' W. 19.83 ch. at E. cor of J. W. How's homestead Set post from which

B Oak 18 in dia at 53° W. 60 lbs  
 " 16 " " S 45° W. 80 "

S 89° 43' W. 69.57 ch. at N. cor of J. W. How's homestead and S. W. cor of Daniel Bollenbough Donation claim Set post from which

B Oak 8 in dia S 3° E. 4.66 lbs  
 " 20 " " at 64° E. 4.82 "

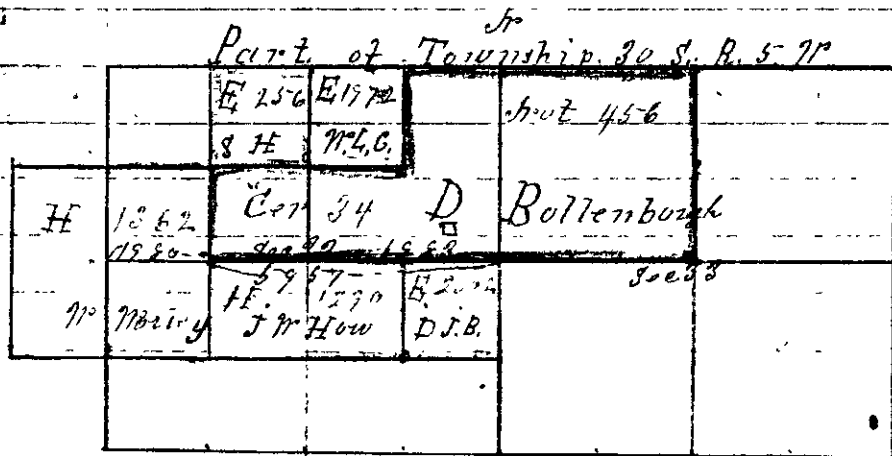

Wm F Briggs  
 Co Surveyor