

- S 10° E, 5.00 high tide mark
- " 51° " 1.50 " " "
- " 60° W, 5.00 Interest Bus line  $\frac{64}{100}$
- South 6.00 To mouth of Cove - West per a cross to opposite side  
By <sup>3 fragments</sup> S 37° W, 8.20
- South 9.50 high tide mark
- S 60° W 2.00 " " "
- N 41° W 5.00 Interest Base line  $\frac{64}{100}$
- S 61° W 5.00 Bluff Rock to River
- N 60° W 3.00 " " "
- S 59° W 4.60 Meander Post Sect / Township 22 R 12

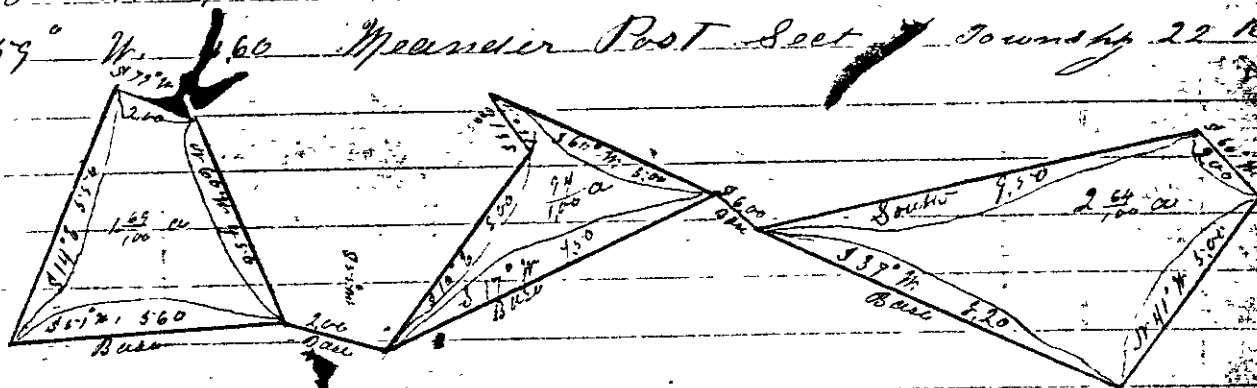

All Sides of 4 chains to the 1 inch

I hereby Certify that the above notes and Plat is a true Copy of Original

Wm F Briggs  
Co. Surveyor

No.	Course	Dist	N	S	E	W	Area	Sum	Acres	Sares
1	S 79° W	2000		38		192	192	192		7296
2	S 65° W	450	225			390	582	774	172	602
3	S 57° E	565	358		490		136	718	252	018
4	S 14° E	300		536	136		000	136		72896
			745-745			82382		424620		30192
								30192		
								342420		
								172214		150000
								150000		500000
								150000		500000
								150000		500000