

DOUGLAS COUNTY SURVEYOR'S OFFICE

Designation: 90-163 Station: 10+00BOP T 27S R 6W S 14 $\frac{1}{4}$ NE

Date Set: 1990 Set by (Agency): A.A. SURVEYING

Date Recovered: 9/08 Recovered by: SJF

- Found New Reset
 Not Found Referenced Destroyed

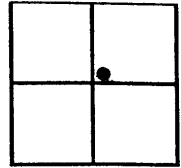

VERTICAL CONTROL

NGVD 29 Elevation: 435.33 Feet File # M 112-20A&B
 Precision: 3RD. ORDER Agency: L.S. 1651 Project: M112-20A&B Date: 1990
 NAVD 88 Elevation: _____ Meters File # _____
 Precision: _____ Agency: _____ Project: _____ Date: _____

HORIZONTAL CONTROL - south zone

N 579889.09 E 4154911.53 Datum/Adj.: NAD 83 Precision: SCALED
 Lat: _____ Long: _____ Agency: _____ File # _____ Date: _____
 N _____ E _____ Datum/Adj.: _____ Precision: _____
 Lat: _____ Long: _____ Agency: _____ File # _____ Date: _____
 N _____ E _____ Datum/Adj.: _____ Precision: _____
 Lat: _____ Long: _____ Agency: _____ File # _____ Date: _____
 N _____ E _____ Datum/Adj.: _____ Precision: _____
 Lat: _____ Long: _____ Agency: _____ File # _____ Date: _____

DESCRIPTION AND TO REACH

A 2 5/8 INCH DIAM. BRASS CAP,
STAMPED "AA SURVEYING INC.", ON
A 1 1/2 X 36 INCH GALV. IRON PIPE,
SET BELOW ASPHALT ROAD SUR-
FACE, UNDER AN 11 1/2 INCH DIAM.
CAST IRON MONUMENT COLLAR
AND COVER.

GO TO THE INTERSECTION OF
NW HARVEY AVE. AND NW KEASEY ST.
IN THE NE QUARTER OF SECTION 14
T27S, R6W. MONUMENT FALLS
NEAR THE CENTER OF THE INTER-
SECTION OF THE TWO STREETS.

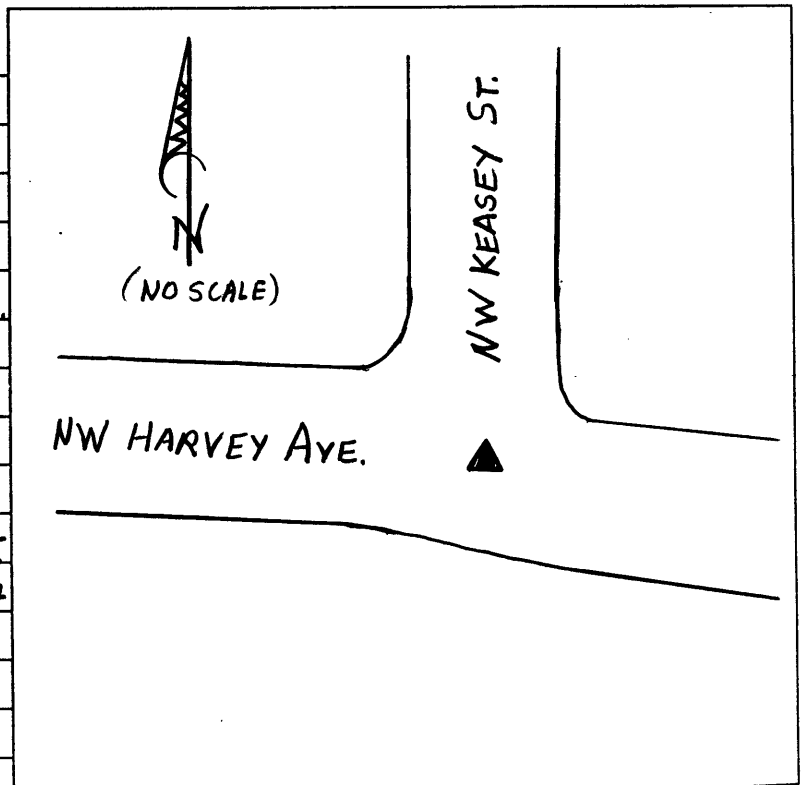

PHOTO FILE NAME

LOCATION

#100-1340 (Renamed 90-163
7/28/09)

~~M092511A~~
BAD FILE

PROCESSED BY: _____

DATE: _____