

OFFICE OF THE
DOUGLAS COUNTY SURVEYOR

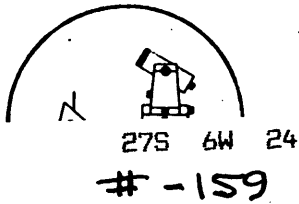

Station: 40-9 R T 27 S, R 6 W, Sec 24
Set By (Agency): CITY (RSBG)
Date Set: ?
Recovered By RWS SJF
Date Recovered 6/2000
Recovered By RWS/SJF/2000
Date Recovered _____
Recovered By _____
Date Recovered _____

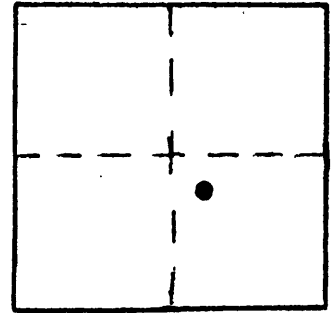

VERTICAL CONTROL NGVD 29

Elevation: 456.60 NGS Line # _____ USGS Line # _____ OSHD Line # _____
Precision: 3rd Agency: DCSD Proj. # 66/38 Date: 2000

HORIZONTAL CONTROL

South Zone State Plane Coordinates: Y(Northing) _____ X(Easting) _____
Precision: _____ Agency: _____ Proj. # _____ Date: _____
Approximate Geographic Position: Latitude 43°12'20.6" Longitude 123°21'13.6"

DESCRIPTION and TO REACH

SKETCH

DESCRIPTION:

A 2 in. diam. brass cap stamped "40-9 R"
set flush in concrete curbing.

TO REACH:

Go to intersection of SE Fullerton St.
and SE Micelli St.

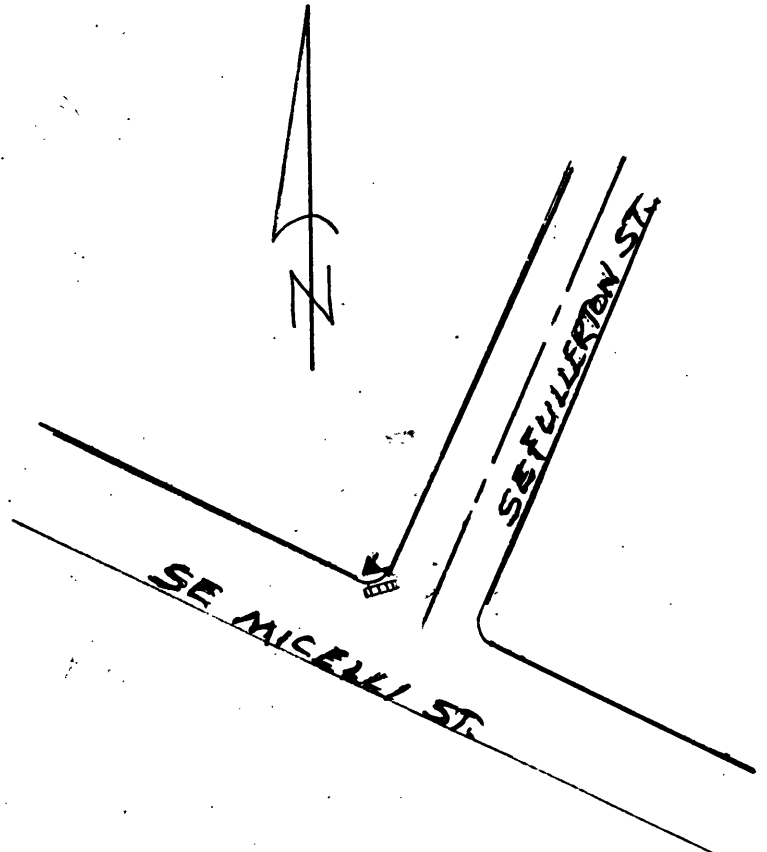

Reference Marks:

Note: For further information, contact the Douglas County Surveyor's Office, Room 205
Douglas County Justice Building, Roseburg, OR 97470. Phone 440-4278. Douglas
County residents outside the Roseburg calling area, dial toll free 1-800-452-0991.