

OFFICE OF THE  
DOUGLAS COUNTY SURVEYOR

Station: 8M T 30 S, R 1E, Sec 10

Set By (Agency): USGS

Date Set: 1944

Recovered By RWS, S.JF

Date Recovered 8/14/87

Recovered By \_\_\_\_\_

Date Recovered \_\_\_\_\_

Recovered By \_\_\_\_\_

Date Recovered \_\_\_\_\_

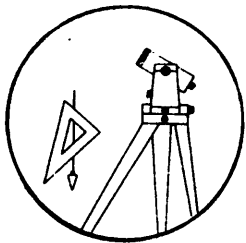

#-141

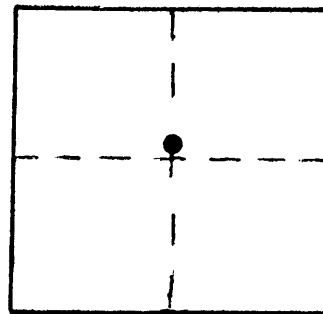

VERTICAL CONTROL NGVD 29

Elevation: 1748.856 ft. NGS Line # \_\_\_\_\_ USGS Line # 113 OSHD Line # \_\_\_\_\_

Precision: 2nd. order Agency: USGS Proj. # \_\_\_\_\_ Date: 1956

HORIZONTAL CONTROL

South Zone State Plane Coordinates: Y(Northing) \_\_\_\_\_ X(Easting) \_\_\_\_\_

Precision: \_\_\_\_\_ Agency: \_\_\_\_\_ Proj. # \_\_\_\_\_ Date: \_\_\_\_\_

Approximate Geographic Position: Latitude \_\_\_\_\_ Longitude \_\_\_\_\_

DESCRIPTION and TO REACH

SKETCH

A USGS disk stamped "8M 1749 1944"  
set in a 8 ft. X 7ft. X 4 ft. high  
boulder.

TO REACH:

Go to Cover Campground up Jackson Creek  
Road (USFS Rd. #29) in T30S,R1E,Sec.10,  
monument is 300 ft. into campground on  
left.

JACKSON CREEK RD (USFS RD #29)

COVER  
CAMPGROUND

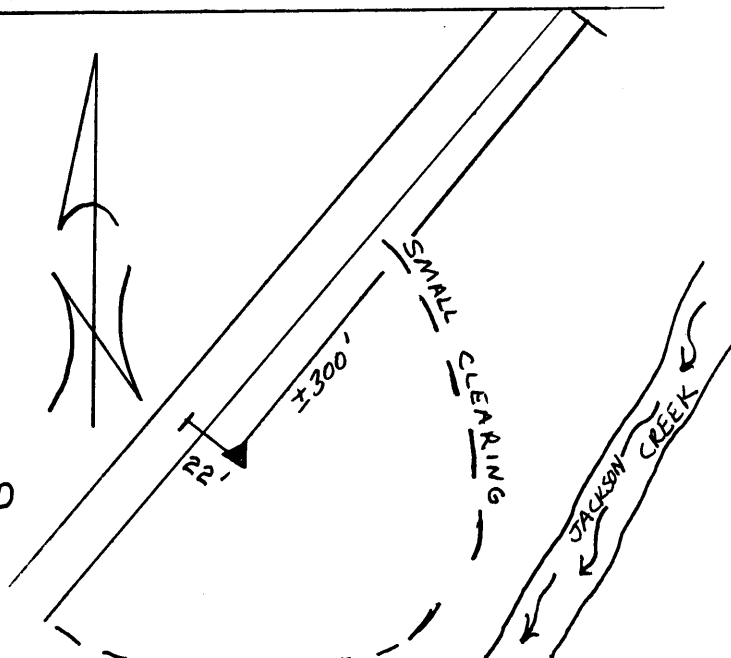

Reference Marks:

Note: For further information, contact the Douglas County Surveyor's Office, Room 205  
Douglas County Justice Building, Roseburg, OR 97470. Phone 440-4278. Douglas  
County residents outside the Roseburg calling area, dial toll free 1-800-452-0991.