

OFFICE OF THE
DOUGLAS COUNTY SURVEYOR

Station: T27R41

T 27 S, R 4W , Sec 1

Date Set: 1986

Set By (Agency): USDA

Date Recovered: 3-9-92

Recovered By: SJF-TF

Date Recovered: _____

Recovered By: _____

Date Recovered: _____

Recovered By: _____

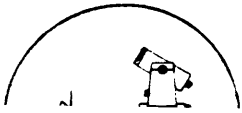
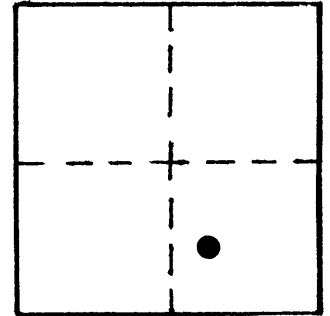

#-136 27S 4W 1

~~27S 4W 1~~ T27R41

NAD 585732.97 4224256.29
83 43°14'38" 123° 6'59"

VERTICAL CONTROL NGVD 29

Elevation: 971.4 NGS Line # _____ USGS Line # _____ OSHD Line # _____

Precision: GPS Agency: DCSO Proj. # 2008 Date: 1992

HORIZONTAL CONTROL

South Zone O.C.S. 27: Y(Northing) 585,768.55 X(Easting) 1,303,297.05

South Zone O.C.S. 83: Y(Northing) _____ X(Easting) _____

Precision: 1/25,000 Agency: DCSO Proj. # 2008 Date: 1992

Approx. NAD 83 Geographic Position: Latitude _____ Longitude _____

DESCRIPTION and TO REACH

SKETCH

Found: A USDA Forest Service 2 1/2" aluminium cap on a 2 3/8" IP firmly set and protruding 1" from ground.

To Reach: At the 8 mi. marker on Buckhorn Rd. See Sketch.

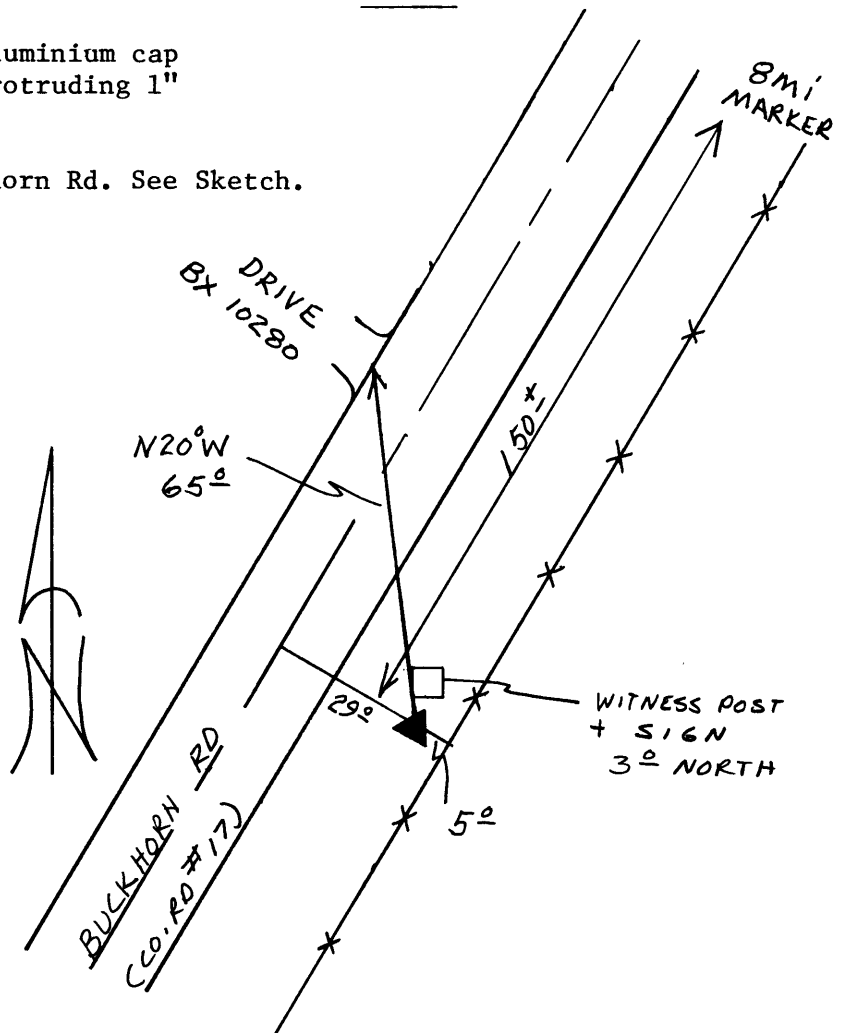

Reference Marks:

Note: For further information, contact the Douglas County Surveyor's Office, Room 205 Douglas County Justice Building, Roseburg, OR 97470. Phone 440-4278. Douglas County residents outside the Roseburg calling area, dial toll free 1-800-452-0991.