

OFFICE OF THE  
DOUGLAS COUNTY SURVEYOR

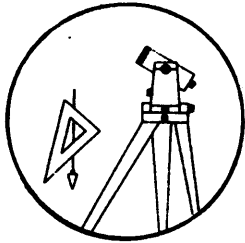

#-133

Station: 1M 1944 1199 T 30 S, R 2W , Sec 22  
 Set By (Agency): USGS  
 Date Set: 1944  
 Recovered By TP-JP  
 Date Recovered 4-28-82  
 Recovered By \_\_\_\_\_  
 Date Recovered \_\_\_\_\_  
 Recovered By \_\_\_\_\_  
 Date Recovered \_\_\_\_\_

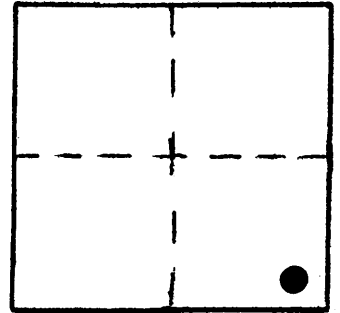

VERTICAL CONTROL NGVD 29

Elevation: 1199.02 NGS Line # \_\_\_\_\_ USGS Line # 114 OSHD Line # \_\_\_\_\_  
 Precision: 3rd Agency: USGS Proj. # \_\_\_\_\_ Date: 1956

HORIZONTAL CONTROL

South Zone State Plane Coordinates: Y(Northing) \_\_\_\_\_ X(Easting) \_\_\_\_\_  
 Precision: \_\_\_\_\_ Agency: \_\_\_\_\_ Proj. # \_\_\_\_\_ Date: \_\_\_\_\_  
 Approximate Geographic Position: Latitude \_\_\_\_\_ Longitude \_\_\_\_\_

DESCRIPTION and TO REACH

Found: A standard USGS Disk set in exposed bedrock stamped "1M 1944 1199"; set 15' above road surface on high cut bank.

To reach: From the intersection of St.Hwy. #227 and Co.Rd. #46 in (sec. 33 T30S R2W) proceed Northerly along Co. Rd. 46 2.1 mi. to monument on the left.

SKETCH

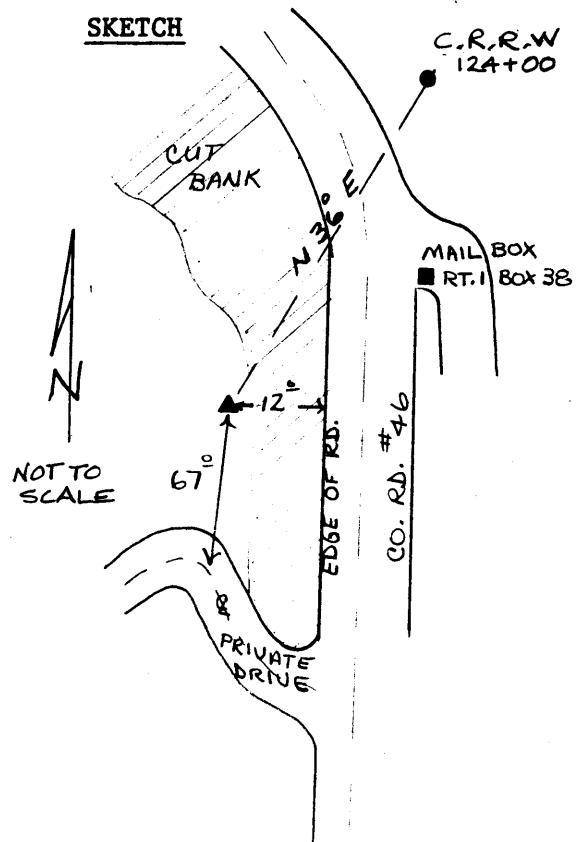

Reference Marks:

Note: For further information, contact the Douglas County Surveyor's Office, Room 205 Douglas County Justice Building, Roseburg, OR 97470. Phone 440-4278. Douglas County residents outside the Roseburg calling area, dial toll free 1-800-452-0991.