

OFFICE OF THE
DOUGLAS COUNTY SURVEYOR

Station: 2 HJH 801 T 29 S, R 4W, Sec 19

Set By (Agency): USGS

Date Set: 1953

Recovered By KR, TP

Date Recovered 4-6-82

Recovered By 8/92 DCSO

Date Recovered _____

Recovered By _____

Date Recovered _____

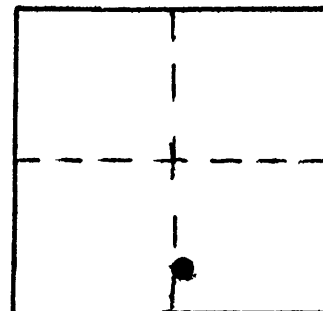

#-101
2 HJH 801

NAD 507835.05 4194902.35
83 43° 1'40" 123°13' 2"

VERTICAL CONTROL **NGVD 29**

Elevation: 800.845 NGS Line # _____ USGS Line # 145 OSHD Line # _____

Precision: 2nd Order Agency: DGSO Proj. # _____ Date: 1992

CS 66147

HORIZONTAL CONTROL

South Zone State Plane Coordinates: Y(Northing) 507,870.73 X(Easting) 1,273,943.90

Precision: 1/25,000 Agency: DCSO Proj. # 2008 Date: 1992

Approximate Geographic Position: Latitude 43° 01' 40" Longitude 123° 12' 57"

DESCRIPTION and TO REACH

SKETCH

Found - A standard USGS disk set in concrete bell tile protruding 5" above ground. The disk has been hit by a mower, but is still intact; stamped "2HJH 801 1953".

To reach from the intersection of Co. Rd. 18 and Co. Rd. 18A, proceed Easterly along Co. Rd. 18 2.0 mi. to station on left. Above intersection is in T29S,R5W,Sec. 23.

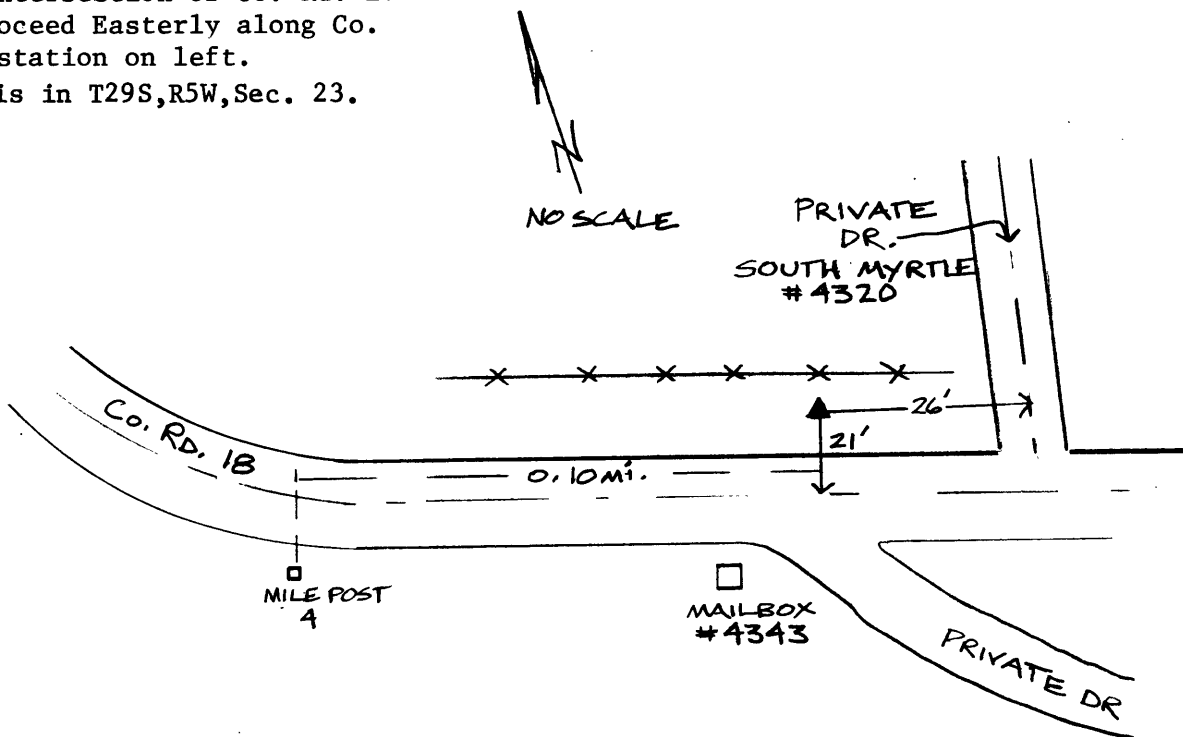

Reference Marks:

□ MILE POST 4

□ MAILBOX #4343

Note: For further information, contact the Douglas County Surveyor's Office, Room 205 Douglas County Justice Building, Roseburg, OR 97470. Phone 440-4278. Douglas County residents outside the Roseburg calling area, dial toll free 1-800-452-0991.