

OFFICE OF THE  
DOUGLAS COUNTY SURVEYOR

Station: 40-7 T 27 S, R 6 W, Sec 24  
 Set By (Agency): CITY (RSBG.)  
 Date Set: ?  
 Recovered By TP, KR  
 Date Recovered 5/82  
 Recovered By RWS-SJF / 2000  
 Date Recovered \_\_\_\_\_  
 Recovered By \_\_\_\_\_  
 Date Recovered \_\_\_\_\_

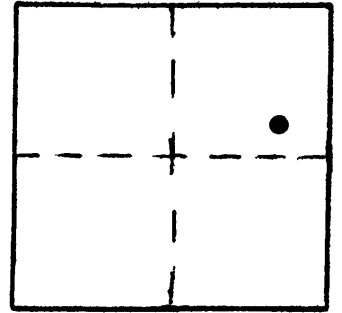

#-093  
40-7

27S 6W 24

NAD 574517.72 4161647.82  
 83 43°12'27" 123°20'60"

VERTICAL CONTROL NGVD 29

Elevation: 466.80 NGS Line # \_\_\_\_\_ USGS Line # \_\_\_\_\_ OSHD Line # \_\_\_\_\_  
 Precision: 3<sup>rd</sup> Agency: DCSO Proj. # 66/38 Date: 2000

HORIZONTAL CONTROL OCS 27

South Zone State Plane Coordinates: Y(Northing) 574,552.92 X(Easting) 1,240,689.48  
 Precision: 1/20,000 Agency: DCSO Proj. # 2005-2 Date: 1983  
 Approximate Geographic Position: Latitude 43°12'28.1" Longitude 123°20'55.3"

DESCRIPTION and TO REACH

SKETCH

DESCRIPTION:

A 0.1 ft. disk stamped "40-7"  
set flush in concrete curbing.

TO REACH:

Go to intersection of SE Sheridan St.  
and SE Mosher Ave.

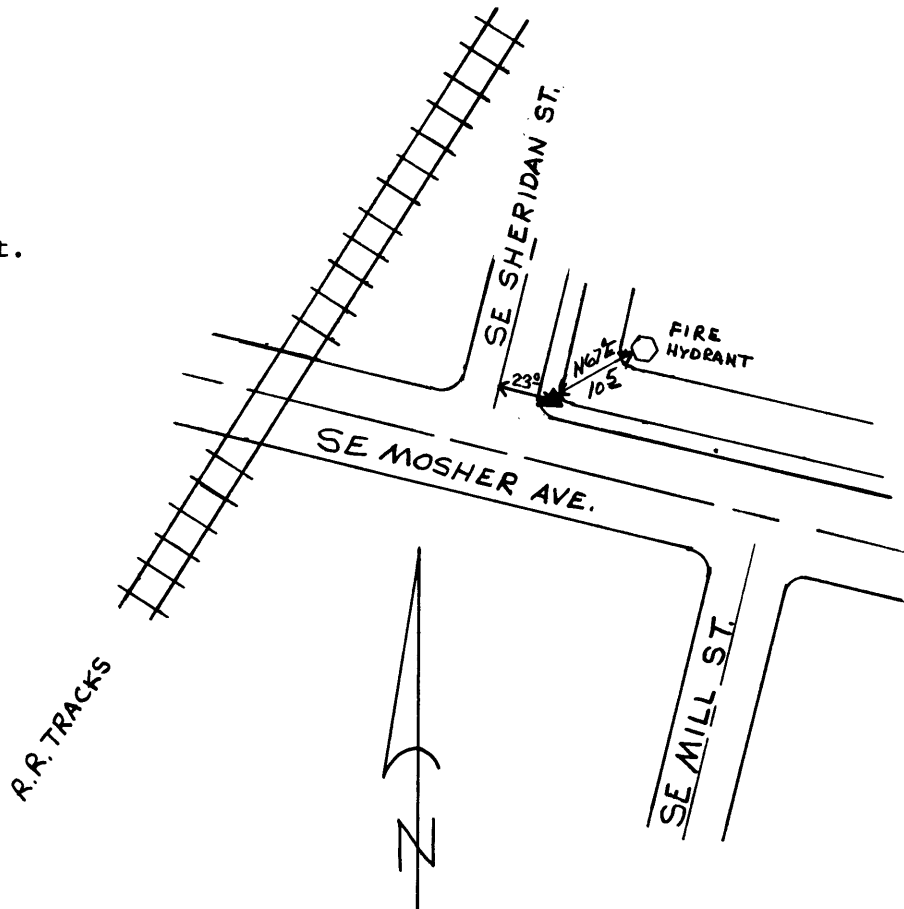

Reference Marks:

Note: For further information, contact the Douglas County Surveyor's Office, Room 205 Douglas County Justice Building, Roseburg, OR 97470. Phone 440-4278. Douglas County residents outside the Roseburg calling area, dial toll free 1-800-452-0991.