

OFFICE OF THE
DOUGLAS COUNTY SURVEYOR

Station: 39-2 T 27 S, R 6 W, Sec 24
 Set By (Agency): CITY (RSBG)
 Date Set: 5/82
 Recovered By KR, TP
 Date Recovered _____
 Recovered By RWS SJF
 Date Recovered 2000
 Recovered By _____
 Date Recovered _____



#-087 27S 6W 24
39-2

NAD 572779.92 4160723.39
83 43°12'10" 123°21'11"

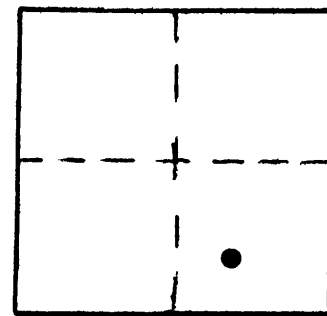

VERTICAL CONTROL NGVD 29
 Elevation: 487.25 NGS Line # _____ USGS Line # _____ OSHD Line # _____
 Precision: 3rd Agency: DCSO Proj. # CS 66/38 Date: 2000

HORIZONTAL CONTROL OCS 27
 South Zone State Plane Coordinates: Y(Northing) 572,815.12 X(Easting) 1,239,765.04
 Precision: 1/20,000 Agency: DCSO Proj. # 2005-2 Date: 1983
 Approximate Geographic Position: Latitude 43°12'10.6 Longitude 123°21'07.0"

DESCRIPTION and TO REACH

SKETCH

DESCRIPTION:

A disk stamped "39-2" set flush in concrete curbing.

TO REACH:

Go to intersection of SE Mill St. and SE Burke Ave.

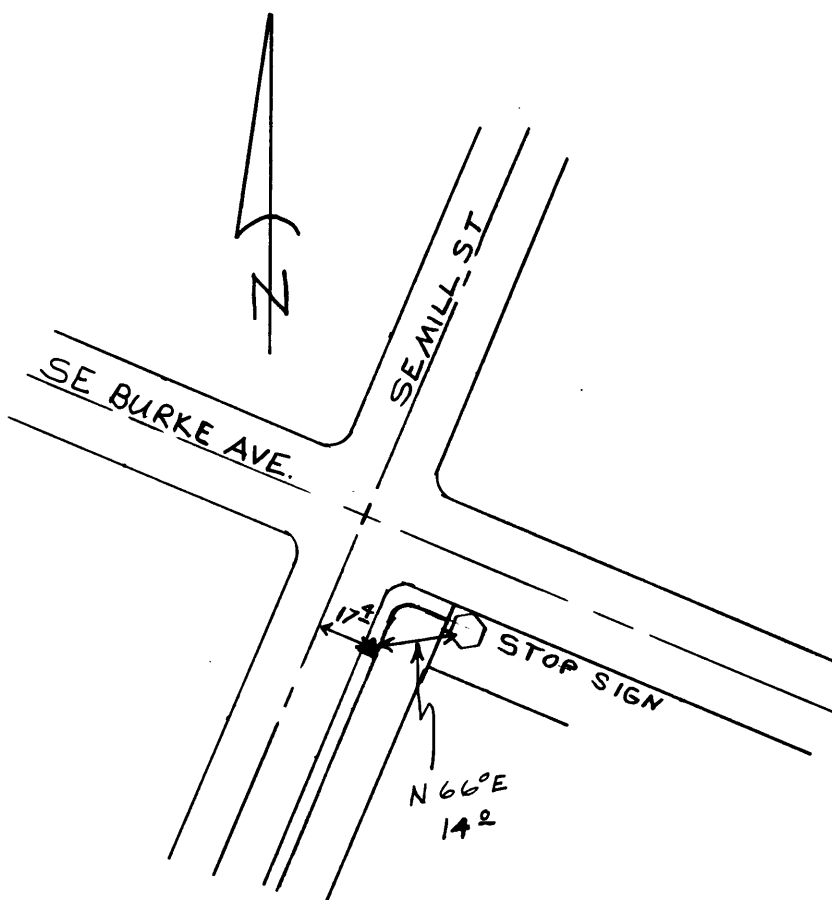

Reference Marks:

Note: For further information, contact the Douglas County Surveyor's Office, Room 205 Douglas County Justice Building, Roseburg, OR 97470. Phone 440-4278. Douglas County residents outside the Roseburg calling area, dial toll free 1-800-452-0991.