

OFFICE OF THE
DOUGLAS COUNTY SURVEYOR

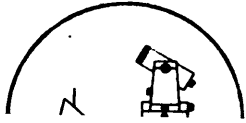

#-074
27-2

275 6W 14

NAD 582071.54 4154689.80
83 43°13'40" 123°22'37"

Station: 27-2 T 27 S, R 6 W, Sec 14
Set By (Agency): City of Rsbg.
Date Set: ?
Recovered By KR,TP
Date Recovered 5/82
Recovered By RWS-SJF
Date Recovered 2000
Recovered By _____
Date Recovered _____

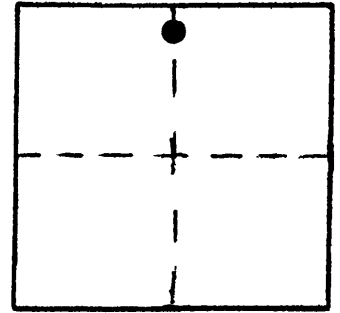

VERTICAL CONTROL NGVD 29

Elevation: ~~439.11~~ 439.41 NGS Line # _____ USGS Line # _____ OSHD Line # _____

Precision: 3rd Agency: City Rsbg. Proj. # 66/38 Date: 2000

HORIZONTAL CONTROL OCS 27

South Zone State Plane Coordinates: Y(Northing) 582,106.66 X(Easting) 1,233,731.46

Precision: 1/20,000 Agency: DCSO Proj. # 2005-2 Date: 1983

Approximate Geographic Position: Latitude 43° 13' 31.0" Longitude 123° 22' 31.5"

DESCRIPTION and TO REACH

SKETCH

DESCRIPTION:

Monument is 0.1 ft. diam. City of Rsbg. brass cap stamped "27-2" set in concrete behind curbing.

TO REACH:

Go to intersection of Calkins Ave. and Keasy St.

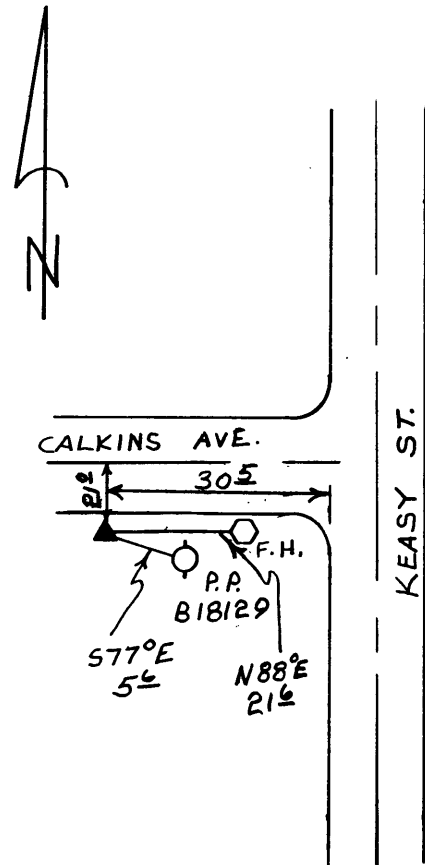

Reference Marks:

Note: For further information, contact the Douglas County Surveyor's Office, Room 205 Douglas County Justice Building, Roseburg, OR 97470. Phone 440-4278. Douglas County residents outside the Roseburg calling area, dial toll free 1-800-452-0991.