

OFFICE OF THE  
DOUGLAS COUNTY SURVEYOR

Station: 17-6. T 27 S, R 6 W, Sec 14

Set By (Agency): CITY (RSBC)

Date Set: ?

Recovered By TP, KR

Date Recovered 5/82

Recovered By RWS-SJF

Date Recovered 2000

Recovered By \_\_\_\_\_

Date Recovered \_\_\_\_\_

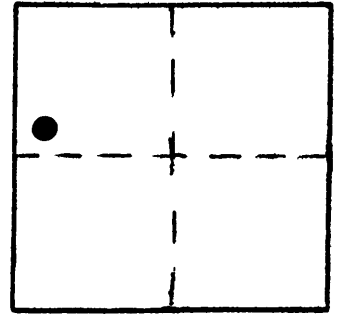

#-065 27S 6W 14  
17-6

NAD 580399.85 4153003.22  
83 43°13'29" 123°22'59"

VERTICAL CONTROL NGVD 29  
429.17

Elevation: ~~429.23~~ NGS Line # \_\_\_\_\_ USGS Line # \_\_\_\_\_ OSHD Line # \_\_\_\_\_

Precision: 3rd Agency: CITY (RSBC) Proj. # 66/38 Date: 2000

HORIZONTAL CONTROL OCS 27  
DCSO

South Zone State Plane Coordinates: Y(Northing) 580,434.96 X(Easting) 1,232,044.86

Precision: 1/20,000 Agency: DCSO Proj. # 2005-2 Date: 1983

Approximate Geographic Position: Latitude 43°13' 23.2 Longitude 123°22' 54.7

DESCRIPTION and TO REACH

SKETCH

DESCRIPTION:

A 0.10 ft. disk stamped "17-6"  
set in concrete post flush with  
ground.

TO REACH:

Go to intersection of NW Garden St.  
and NW Riverview Dr., proceed westarily  
along NW Riverview Dr. approx. 146 ft.  
to monument on left.

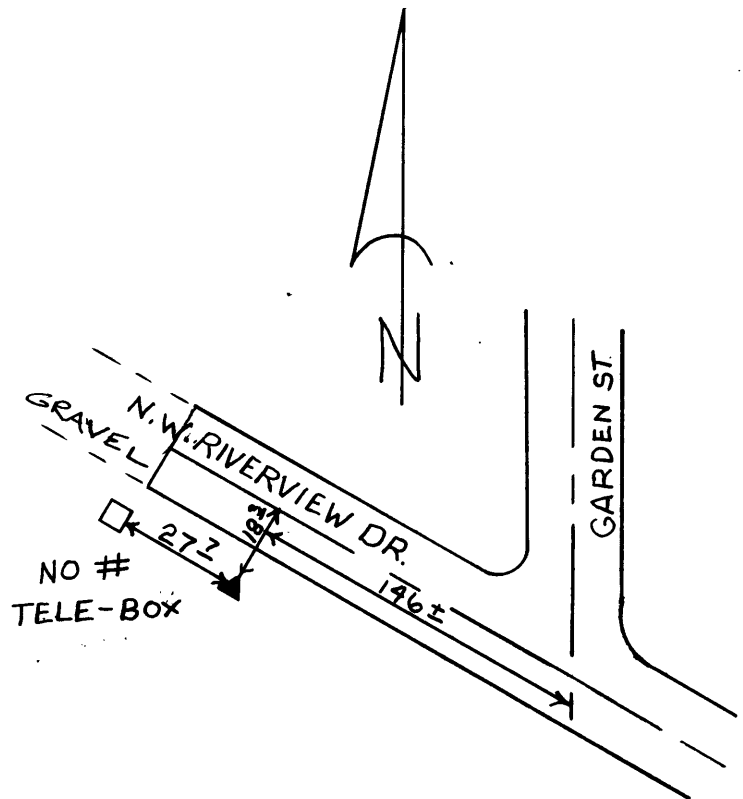

Reference Marks:

Note: For further information, contact the Douglas County Surveyor's Office, Room 205 Douglas County Justice Building, Roseburg, OR 97470. Phone 440-4278. Douglas County residents outside the Roseburg calling area, dial toll free 1-800-452-0991.