

OFFICE OF THE
DOUGLAS COUNTY SURVEYOR

Station: 66-2 T 27 S, R 5W , Sec 20

Set By (Agency): City (Rsbg.)

Date Set: _____

Recovered By GEQ,JP,TP

Date Recovered 6/82

FO OK PER HEIMBURGER 1995-0108

Recovered By DCSO - 7/98

Date Recovered _____

Recovered By _____

Date Recovered _____

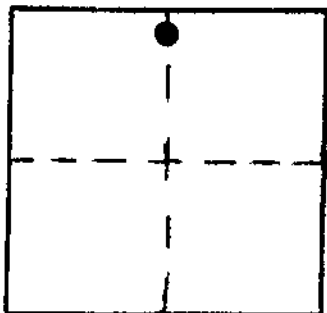

#-042 27S 5W 20
66-2

NAD 576198.41 4170830.37
83 43°12'47" 123°18'56"

VERTICAL CONTROL NGVD 29

Elevation: 507.95 NGS Line # _____ USGS Line # _____ OSHD Line # _____

Precision: 3rd Agency: DCSO Proj. # 2007 Date: 7/98

CS # 66/57

HORIZONTAL CONTROL OCS 27

South Zone State Plane Coordinates: Y(Northing) 576,233.67 X(Easting) 1,249,872.06

Precision: 1/20,000 Agency: DCSO Proj. # 2005-2 Date: 1983

Approximate Geographic Position: Latitude 43°12'48" Longitude 123°18'52"

DESCRIPTION and TO REACH

SKETCH

DESCRIPTION:

Monument is a 0.1 ft. diam. City of Rsbg. brass disk stamped "66-2" set in concrete curbing.

TO REACH:

Monument is at the intersection of Diamond Lake Blvd. and Miguel St.

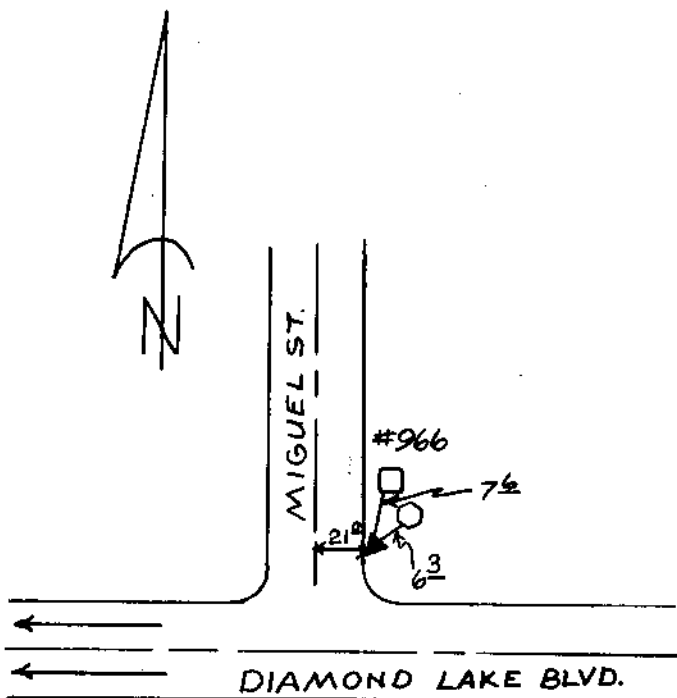

Reference Marks:

Note: For further information, contact the Douglas County Surveyor's Office, Room 205 Douglas County Justice Building, Roseburg, OR 97470. Phone 440-4278. Douglas County residents outside the Roseburg calling area, dial toll free 1-800-452-0991.