

OFFICE OF THE
DOUGLAS COUNTY SURVEYOR



#-040 27S 5W 19
57-2

NAD 576297.93 4166801.18
83 43°12'47" 123°19'51"

Station: 57-2 T 27 S, R 5 W, Sec 19
 Set By (Agency): City (Rsbg.)
 Date Set: _____
 Recovered By GEQ, KR, JP
 Date Recovered 6/82
 Recovered By DCSO 7/98
 Date Recovered _____
 Recovered By _____
 Date Recovered _____

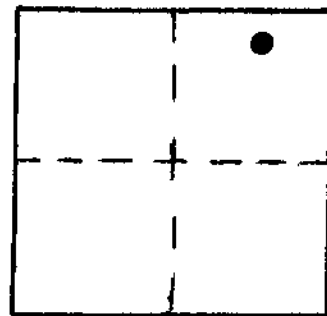

VERTICAL CONTROL NGVD 29

Elevation: 459.01 NGS Line # _____ USGS Line # _____ OSHD Line # _____
 Precision: 3rd Agency: DCSO CS# 66157 Proj. # 2007 Date: 7/98

HORIZONTAL CONTROL OCS 27

South Zone State Plane Coordinates: Y(Northing) 576,333.16 X(Easting) 1,245,842.87
 Precision: 1/20,000 Agency: DCSO Proj. # 2005-2 Date: 1983
 Approximate Geographic Position: Latitude 43°12'47" Longitude 123°19'47"

DESCRIPTION and TO REACH

SKETCH

DESCRIPTION:

Monument is a 0.1 ft. City of Rsbg. disk stamped "57-2" set in concrete curb.

TO REACH:

Monument is at the intersection of Diamond Lake Blvd. and Bogard St.

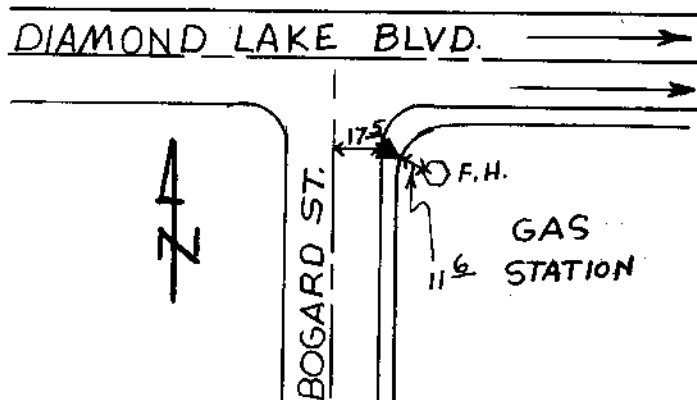

Reference Marks:

Note: For further information, contact the Douglas County Surveyor's Office, Room 205 Douglas County Justice Building, Roseburg, OR 97470. Phone 440-4278. Douglas County residents outside the Roseburg calling area, dial toll free 1-800-452-0991.