

OFFICE OF THE
DOUGLAS COUNTY SURVEYOR



#-037 27S 5W 19
56-1

NAD 575249.00 4166864.43
83 43°12'36" 123°19'50"

Station: 56-1 T 27 S, R 5W, Sec 19
 Set By (Agency): City (Rsbg.)
 Date Set: ?
 Recovered By KR, TP
 Date Recovered 5/82
 Recovered By DCSO 7/98
 Date Recovered _____
 Recovered By _____
 Date Recovered _____

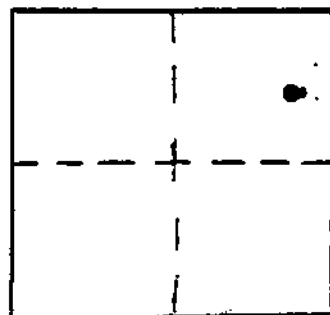

VERTICAL CONTROL NGVD 29
 Elevation: 469.35 NGS Line # _____ USGS Line # _____ OSHD Line # _____
 Precision: 3rd Agency: DCSO Proj. # 2007 Date: 7/98

HORIZONTAL CONTROL OCS 27
 South Zone State Plane Coordinates: Y(Northing) 575,284.24 X(Easting) 1,245,906.12
 Precision: 1/20,000 Agency: DCSO Proj. # 2005-2 Date: 1983
 Approximate Geographic Position: Latitude 43°12'37" Longitude 123°19'45"

DESCRIPTION and TO REACH

SKETCH

DESCRIPTION:

A brass disk stamped "56-1" set flush in concrete curbing.

TO REACH:

Go to intersection of SE Douglas Ave. and SE Leland St.

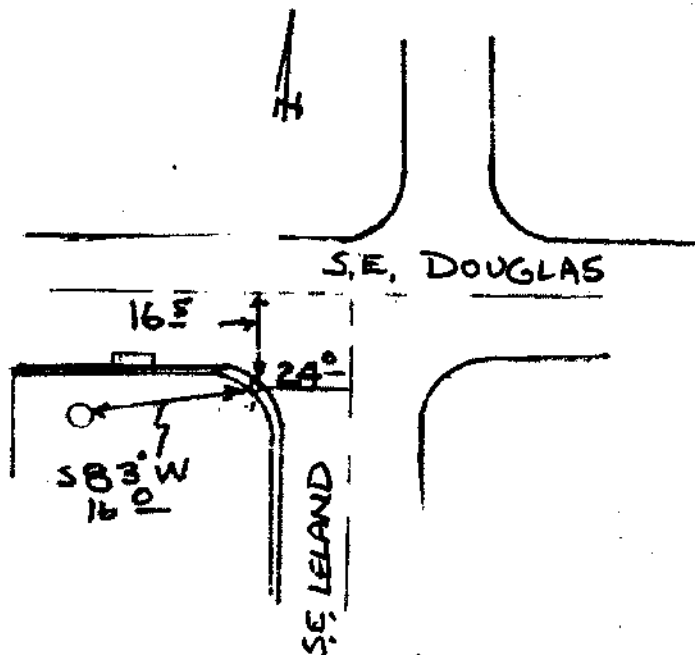

Reference Marks:

Note: For further information, contact the Douglas County Surveyor's Office, Room 205 Douglas County Justice Building, Roseburg, OR 97470. Phone 440-4278. Douglas County residents outside the Roseburg calling area, dial toll free 1-800-452-0991.