

OFFICE OF THE
DOUGLAS COUNTY SURVEYOR

Station: 51-7 T 27 S, R 5 W, Sec 19

Set By (Agency): CITY (RSEB)

Date Set: ?

Recovered By KR, TP

Date Recovered 5/82

Recovered By DCSO 7/98

Date Recovered _____

Recovered By _____

Date Recovered _____

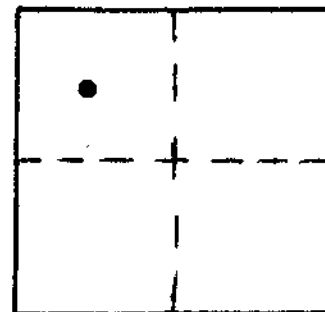

#-029 27S 5W 19
51-7

NAD 83 375070.40 4163781.34
43°12'34" 123°20'31"

NGVD 29
VERTICAL CONTROL

Elevation: 491.98 NGS Line # _____ USGS Line # _____ OSHD Line # _____

Precision: 3rd Agency: DCSO O.S. # 66/57 Date: 7/98
oj. # 2007

HORIZONTAL CONTROL OCS 27

South Zone State Plane Coordinates: Y(Northing) 575,105.61 X(Easting) 1,242,823.02

Precision: 1/20,000 Agency: DCSO Proj. # 2005-2 Date: 1983

Approximate Geographic Position: Latitude 43°12'34" Longitude 123°20'27"

DESCRIPTION and TO REACH

SKETCH

DESCRIPTION:

A disk stamped "51-7" set flush in a concrete sidewalk.

TO REACH:

Go to intersection of SE Kane St. and SE Washington Ave.

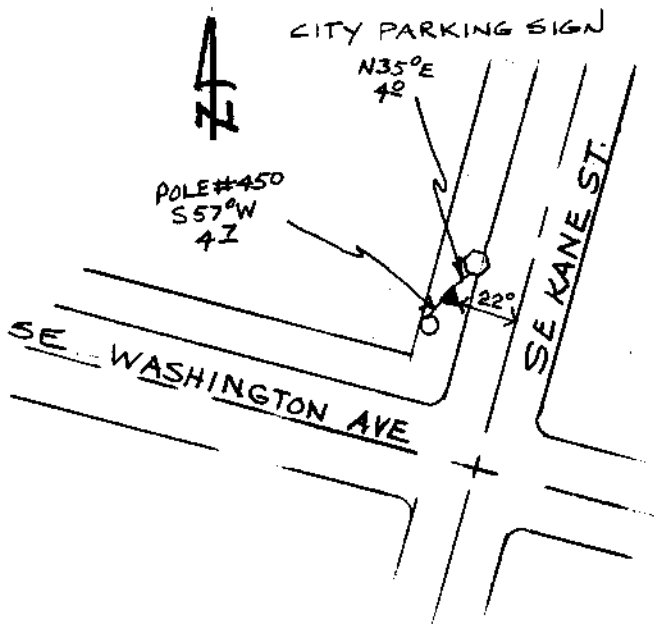

Reference Marks:

Note: For further information, contact the Douglas County Surveyor's Office, Room 205 Douglas County Justice Building, Roseburg, OR 97470. Phone 440-4278. Douglas County residents outside the Roseburg calling area, dial toll free 1-800-452-0991.