

OFFICE OF THE
DOUGLAS COUNTY SURVEYOR



#-018
50-2

27S 5W 19

NAD 576497.38 4164900.62
83 43°12'48" 123°20'17"

Station: 50-2
Set By (Agency): OSHD
Date Set: ?
Recovered By KR, TP
Date Recovered 6/82
Recovered By DCSO 7/98
Date Recovered _____
Recovered By _____
Date Recovered _____

T 27 S, R 5 W , Sec 19 B

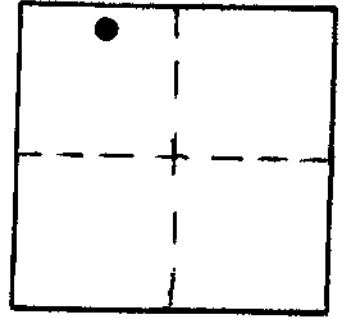

VERTICAL CONTROL NGVD 29

Elevation: 448.11 NGS Line # _____ USGS Line # _____ OSHD Line # _____
Precision: 3rd Agency: DCSO Proj. # 2007 Date: 7/98

HORIZONTAL CONTROL OCS 27

South Zone State Plane Coordinates: Y(Northing) 576,532.60 X(Easting) 1,243,942.31
Precision: _____ Agency: DCSO Proj. # 2005-2 Date: 1/83
Approximate Geographic Position: Latitude 43° 12' 49" Longitude 123° 20' 12"

DESCRIPTION and TO REACH

SKETCH

DESCRIPTION:

Monument is a 2½ inch diam. City of Roseburg disk stamped "TO CENTER LINE" set in concrete driveway flush with ground.

TO REACH:

Go to intersection of N.E. Atlanta St. and Diamond Lake Blvd. proceed E'LY along Diamond lake Blvd. 200± ft. to monument on right.

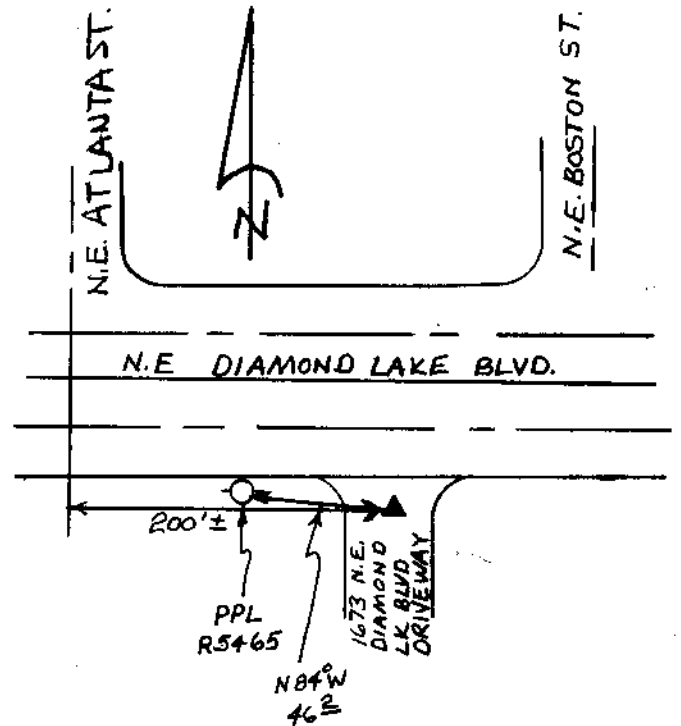

Reference Marks:

Note: For further information, contact the Douglas County Surveyor's Office, Room 205 Douglas County Justice Building, Roseburg, OR 97470. Phone 440-4278. Douglas County residents outside the Roseburg calling area, dial toll free 1-800-452-0991.