

OFFICE OF THE

#-012  
497-B

26S 5W 18

DOUGLAS COUNTY SURVEYOR

NAD 611268.89 4164856.05  
83 43°18'31" 123°20'33"

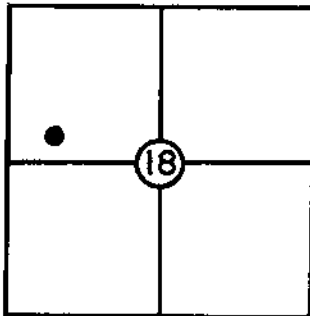

T 26 S, R 5 W, Sec. 18

Station: 497-B

Set By (Agency): USGS

Date: 1903

*NGVD 29*

VERTICAL CONTROL

Elevation: 498.290 NGS(USG&GS) Line # 6 USGS Line # \_\_\_\_\_

Order Of Precision 1st Agency: USC&GS Proj. #: \_\_\_\_\_ Date: 1956

*OLC 27*

HORIZONTAL CONTROL

Oregon State Plane Coordinates: Y(Northing) 611,303.85 X(Easting) 1,243,897.00  
(South Zone)

Order Of Precision 1/50,000 Agency: DCSO Proj. #: 2004-11 Date: 1976

Approximate Geographic Position: Latitude= \_\_\_\_\_ Longitude= \_\_\_\_\_

DESCRIPTION: Brass cap marked "497-B 1903"  
cemented in concrete block 1'x1'x1' above  
grade; station is approximately 1,930 feet +  
E. of Hwy 99 South down RR track and approx.  
25 feet to right of RR tracks.

SKETCH

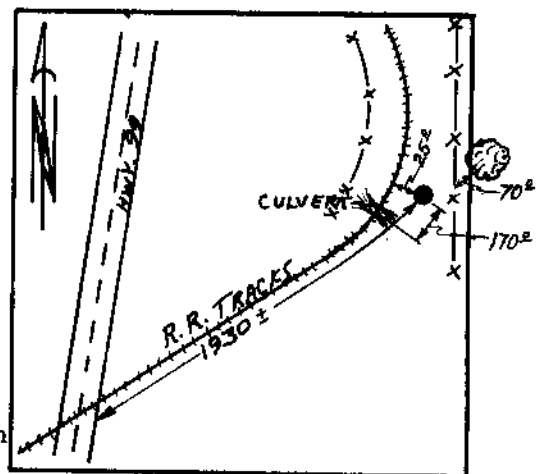

VICINITY: Approximately 1.2 mi. N. on Hwy 99 South  
from Winchester exit off I-5.

NOTE: For Possible Further Information On This Station, Please Contact The Douglas County Surveyors Office, Rm. 205 Douglas County Justice Bldg., Roseburg, OR. 97470 Phone 672-3311 Ext. 272.. Douglas County residents outside the Roseburg calling area dial toll free 1-800-452-0991.