

OFFICE OF THE
DOUGLAS COUNTY SURVEYOR

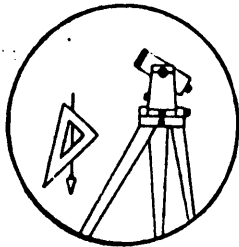

Station: N 255 T 31 S, R 5 W , Sec 23
 Set By (Agency): USC&GS
 Date Set: 1934
 Recovered By RS,JP
 Date Recovered 9/15/83
 Recovered By _____
 Date Recovered _____
 Recovered By _____
 Date Recovered _____

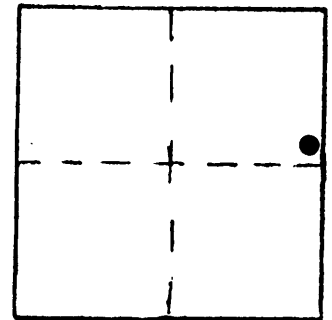

N 005

VERTICAL CONTROL NGVD 29

Elevation: 1,263.19 NGS Line # _____ USGS Line # _____ OSHD Line # 310
 Precision: 3rd Agency: OSHD Proj. # _____ Date: 1957

HORIZONTAL CONTROL

South Zone State Plane Coordinates: Y(Northing) _____ X(Easting) _____
 Precision: _____ Agency: _____ Proj. # _____ Date: _____
 Approximate Geographic Position: Latitude _____ Longitude _____

DESCRIPTION and TO REACH

SKETCH

DESCRIPTION:

A disk stamped "N 255 1934" set flush with ground in a concrete post. Witness post and sign on westerly side.

TO REACH:

From the Canyon Cr. Rd. overpass over I-5 in T31S,R5W,Sec.2, proceed southerly along I-5 3.0 miles to mile post 93.

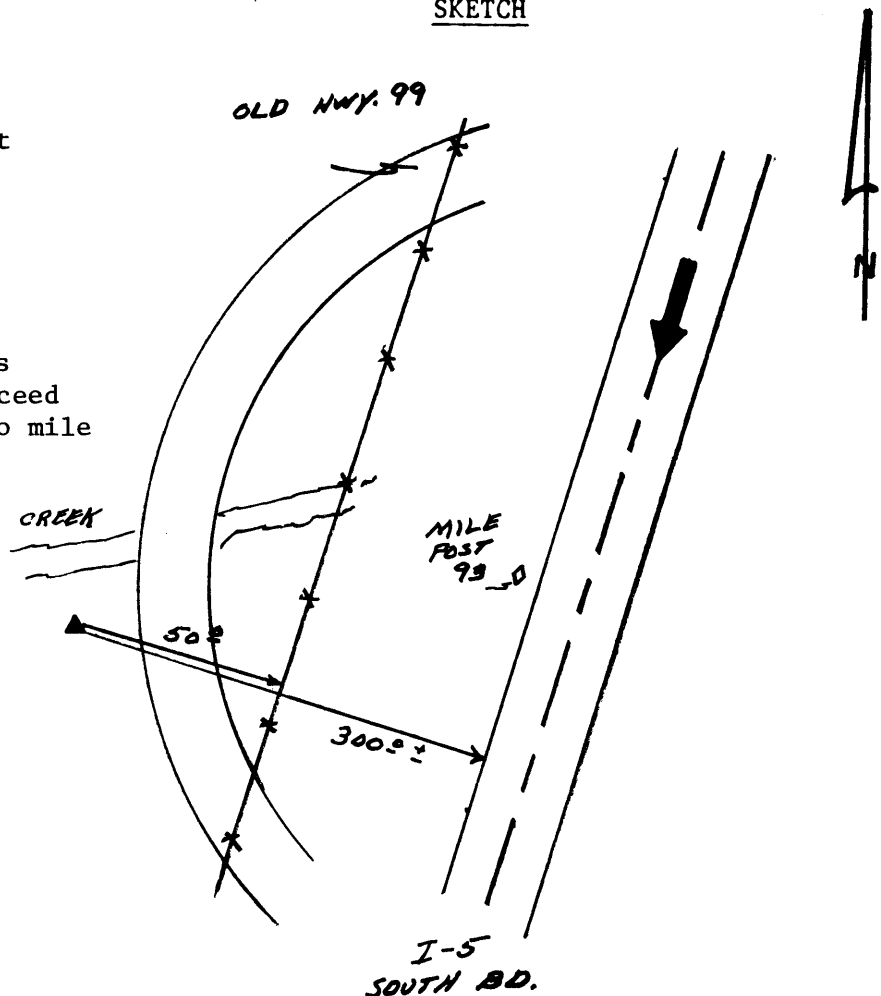

Reference Marks:

Note: For further information, contact the Douglas County Surveyor's Office, Room 205 Douglas County Justice Building, Roseburg, OR 97470. Phone 440-4278. Douglas County residents in the Roseburg calling area, dial toll free 1-800-452-0991.