

Date Set: 1991

Set By (Agency): PLS #2391

DCSO Designation: M-089

Date Recovered: 1/21/93

Recovered By: RWS SJF

Date Recovered: _____

Recovered By: _____

Date Recovered: _____

Recovered By: _____

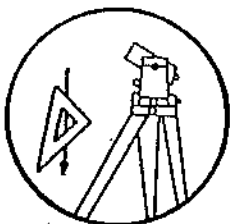
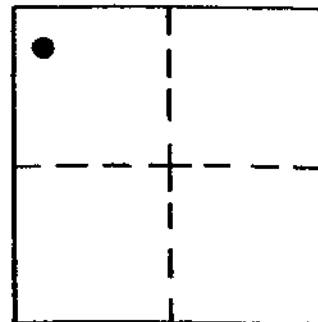

M 089

VERTICAL CONTROL

Elevation: 1009.598

NGS Line # _____ USGS Line # _____ OSHD Line # _____

Precision: 2nd Order Agency: PLS 2391

Proj. # _____

Date: 1992

HORIZONTAL CONTROL

O.C.S. 27 Y(Northing): 470,199.41

O.C.S. 83 Y(Northing): 470,163.31

South Zone X(Easting): 1,336,294.56

South Zone X(Easting): 4,257,252.93

Precision: 1/25000 Agency: DCSO

Proj. # 2008

Date: 1992

Approx. NAD 83 Geographic Position: Latitude 42°55'47"

Longitude 122°58'47"

Found: A 3" dia. NGS disk stamped "M500 RESET 1991" set flush in top of a 12" dia. concrete post protruding 3" above ground.

To Reach: From the intersection of Tiller Trail Hwy. (Co.Rd.#1) and South Umpqua Rd. (Co.RD.#46) in T30S R2W sec. 33 proceed westerly along Tiller Trail Hwy. approx. 1.5 mi. to mon. on the right.

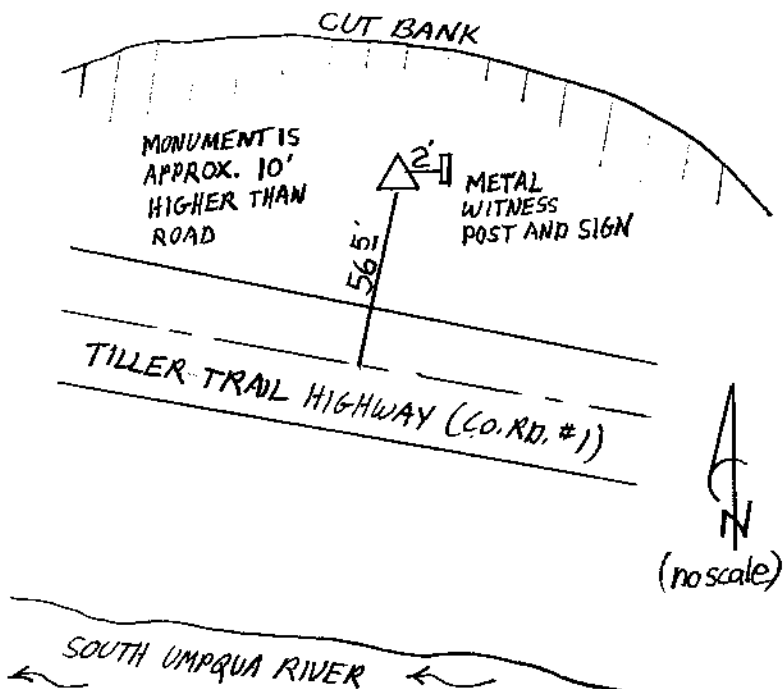

Note: For possible further information contact the Douglas County Surveyors Office, Room 205 Douglas County Justice Building, Roseburg, OR 97470. Phone 440-4272. Douglas County residents outside the Roseburg calling area, dial toll free 1-800-477-0991.