

OFFICE OF THE
DOUGLAS COUNTY SURVEYOR

Station: X-049

T 29 S, R 4 W, Sec 30

Date Set: 1992

Set By (Agency): DCSO

DCSO Designation: X-049

Date Recovered: 7/92

Recovered By: TF HS

Date Recovered: _____

Recovered By: _____

Date Recovered: _____

Recovered By: _____

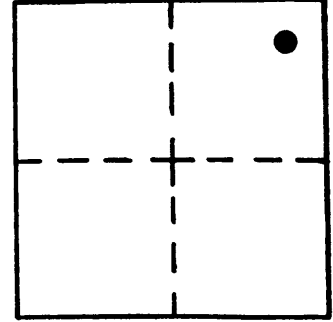
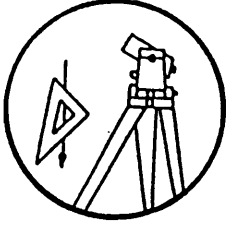

VERTICAL CONTROL **NGVD29**

Elevation: 786.613 NGS Line # _____ USGS Line # _____ OSHD Line # _____

Precision: 2ND ORDER Agency: DCSO Proj. # 2007 Date: 1992

CS 664-7

HORIZONTAL CONTROL

O.C.S. 27 Y(Northing): _____ O.C.S. 83 Y(Northing): _____

South Zone X(Easting): _____ South Zone X(Easting): _____

Precision: _____ Agency: _____ Proj. # _____ Date: _____

Approx. NAD 83 Geographic Position: Latitude 43°01'26" Longitude 123°12'33"

Scaled 27

Set: A standard DCSO disk stamped "X-049 1992"
set in a 6" x 36" corrugated sewer pipe protruding
3" from the ground and filled with concrete.

To reach: From the intersection of South Myrtle
Rd. (Co.Rd.#18) and Riverside Dr. (Co.Rd.#18A) in
T29S R5W sec. 23, continue on South Myrtle Rd. easterly
2.5mi. to mon. on the right.

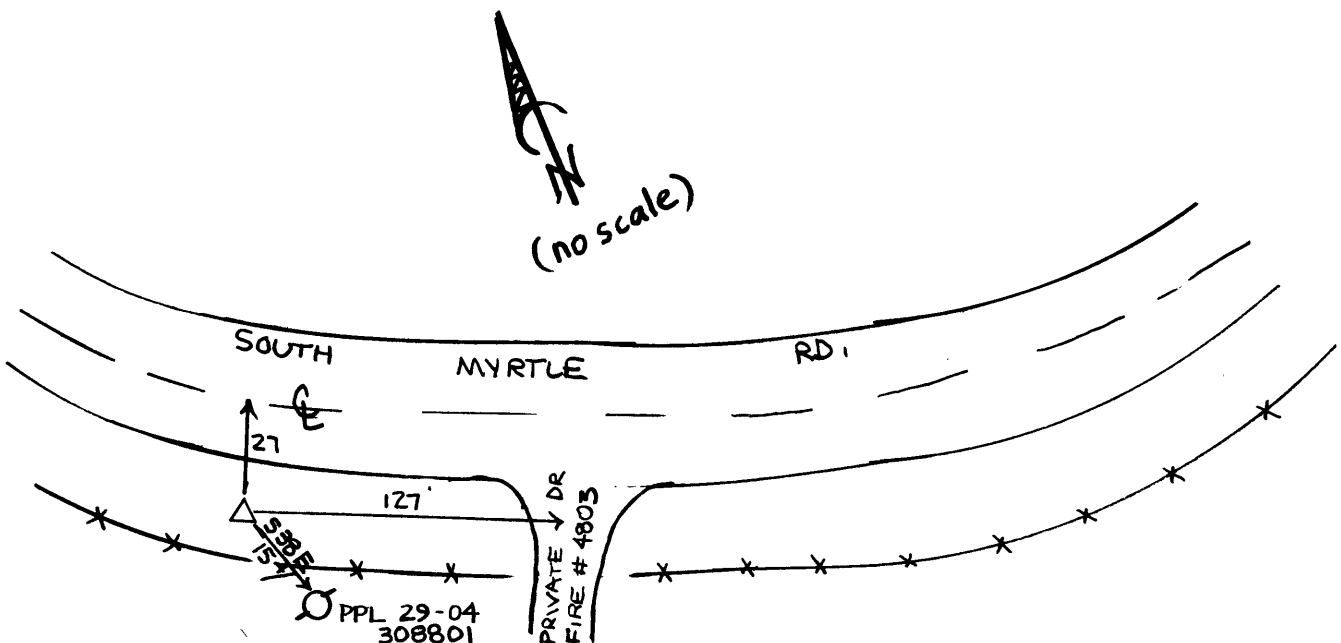

Note: For possible further information contact the Douglas County Surveyors Office,
Room 205 Douglas County Justice Building, Roseburg, OR 97470. Phone 440-4272.
Douglas County residents outside the Roseburg calling area, dial toll free
1-800-477-0991.