

OFFICE OF THE
DOUGLAS COUNTY SURVEYOR

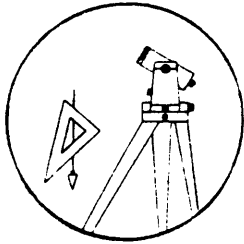

Station: FUD T 29 S, R 4W, Sec 18
 Date Set: 1990
 Set By (Agency): DCSO
 Date Recovered: 1/8/91
 Recovered By: SJF - TF
 Date Recovered: _____
 Recovered By: _____
 Date Recovered: _____
 Recovered By: _____

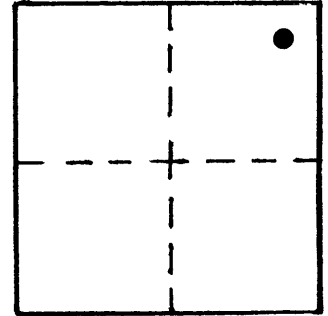

DES. F-037

VERTICAL CONTROL **NGVD 29**

Elevation: 766.238 NGS Line # _____ USGS Line # _____ OSHD Line # _____
 Precision: 2nd Agency: DCSO Proj. # 2007 Date: 1990

HORIZONTAL CONTROL

CS66/43

South Zone O.C.S. 27: Y(Northing) _____ X(Easting) _____
 South Zone O.C.S. 83: Y(Northing) _____ X(Easting) _____
 Precision: _____ Agency: _____ Proj. # _____ Date: _____

Approx. NAD ~~83~~ ₂₇ Geographic Position: Latitude 43°03'15" Longitude 123°12'31"

DESCRIPTION and TO REACH

SKETCH

A standard DCSO disk stamped "FUD 1990" set in a 8" x 40" concrete filled belltile protruding 3" above ground.
 To reach:
 From the intersection of North Myrtle Rd. (Co. Rd. #15) and Bilger Creek Rd. (Co. Rd. #103) in T29S, R5W, sec. 14 proceed northeasterly along North Myrtle Rd. 2.75 mi. to mon. on the left.

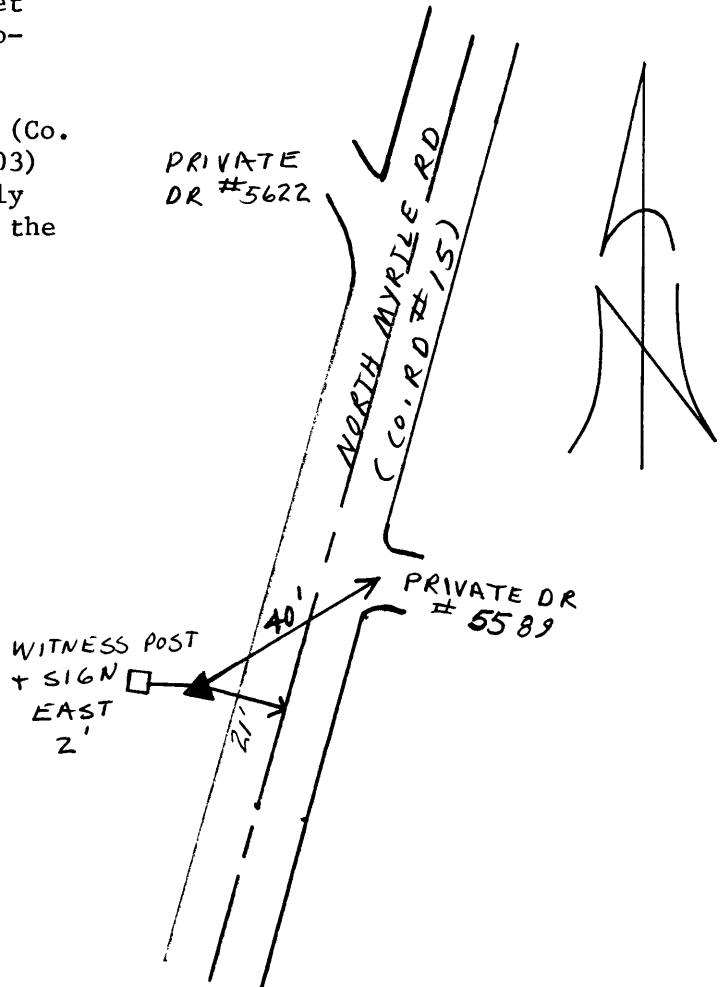

Reference Marks:

Note: For further information, contact the Douglas County Surveyor's Office, Room 205 Douglas County Justice Building, Roseburg, OR 97470. Phone 440-4278. Douglas County residents outside the Roseburg calling area, dial toll free 1-800-452-0991.