

OFFICE OF THE
DOUGLAS COUNTY SURVEYOR

Station: E 741X

T28S R7W Sec. 28

Date Set: 1987

Set By (Agency): NGS

DCSO Designation: E-032

Date Recovered: 8-93

Recovered By: RWS S.JF

Date Recovered: _____

Recovered By: _____

Date Recovered: _____

Recovered By: _____

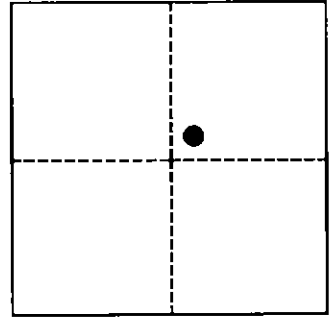
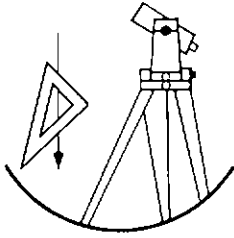

VERTICAL CONTROL

NGVD 29 Elevation: _____ FEET NAVD 88 Elevation: 208.191 METERS

NGS Line # 125034 USGS LINE # _____ OSHD Line # _____ FILE # _____

Precision: 1ST ORDER Agency: NGS Proj: _____ Date: 1988

HORIZONTAL CONTROL

O.C.S. 27 Y(Northing): _____ O.C.S. 83 Y(Northing): _____

(South Zone) X(Easting): _____ (South Zone) X(Easting): _____

Precision: _____ Agency: _____ Proj: _____ Date: _____

Approx. O.C.S. 27 Geographic Position: Latitude: 43°06'30" Longitude: 123°31'46"

Approx. O.C.S. 83 Geographic Position: Latitude: _____ Longitude: _____

Found: A 9/16 inch diameter stainless steel rod under a 6 - 5/8 inch diameter aluminum collar and access cover set in concrete, flush with ground, collar stamped "E 741X 1987".

To reach: Go the intersection of State Hwy 42 and Tenmile Valley Rd. (Co. Rd. #109) in T29S R7W Sec28 monument is northeast of intersection.

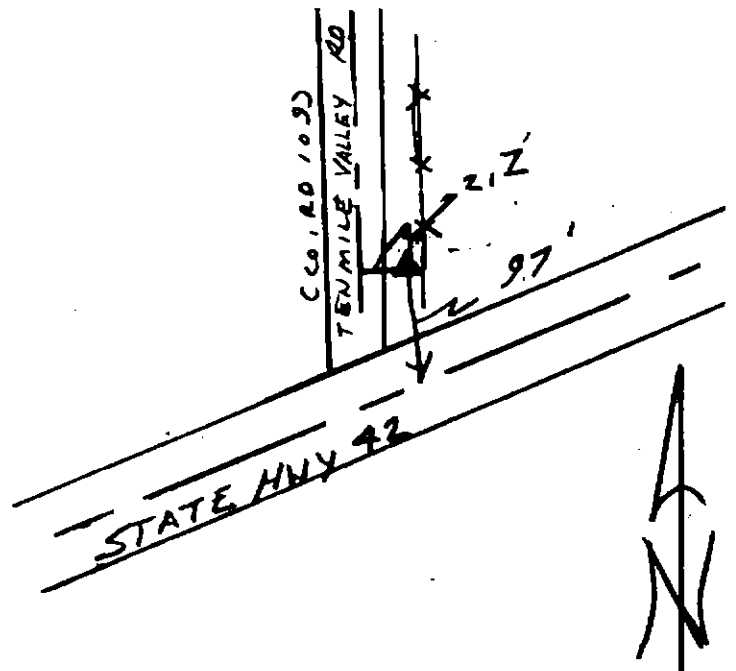

Note: For further information contact the Douglas County Surveyors Office, Room 205 Douglas County Justice Building, Roseburg, OR 97470. Phone 440-4272. Douglas County Residents outside Roseburg calling area, dial toll free 1-800-477-0991.