

OFFICE OF THE
DOUGLAS COUNTY SURVEYOR

Station: E 554 T 28 S, R 6W, Sec 29

Set By (Agency): USC&GS

Date Set: 954

Recovered By R.S., S.J.F.

Date Recovered March 19, 1984

Recovered By _____

Date Recovered _____

Recovered By _____

Date Recovered _____

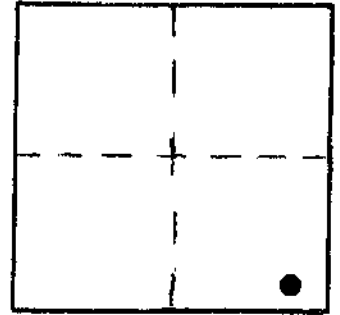

e-006
E 554

28S 6W 29

NAD 536032.55 4139602.70
83 43° 6' 0" 123°25'39"

VERTICAL CONTROL **NGVD 29**

Elevation: 522.463 NGS Line # 6 USGS Line # _____ OSHD Line # _____

Precision: 1st Agency: USC&GS Proj. # _____ Date: 1957

HORIZONTAL CONTROL **OCS 27**

South Zone State Plane Coordinates: Y(Northing) 536,067.68 X(Easting) 1,218,644.45

Precision: 1/25,000 Agency: DCSO Proj. # 2008-2013 Date: 1984

Approximate Geographic Position: Latitude 43°06'01" Longitude 123°25'35"

DESCRIPTION and TO REACH

A USC&GS disk stamped "E 554 1954" set flush in a 2 1/2 Ft. X 4 1/2 Ft. concrete foundation of a former SPRR station signal.

To Reach:

In Dillard, go to the intersection of Dyke Rd. (Co. Rd. #158) and State Highway 99 in T28S, R6W, Sec. 29. Monument is approximately 200 Ft. East and 100 Ft. South from above mentioned intersection and on Roseburg Lumber private property.

DYKE RD.
CO. RD. #
158

DILLARD
POST
OFFICE

SKETCH

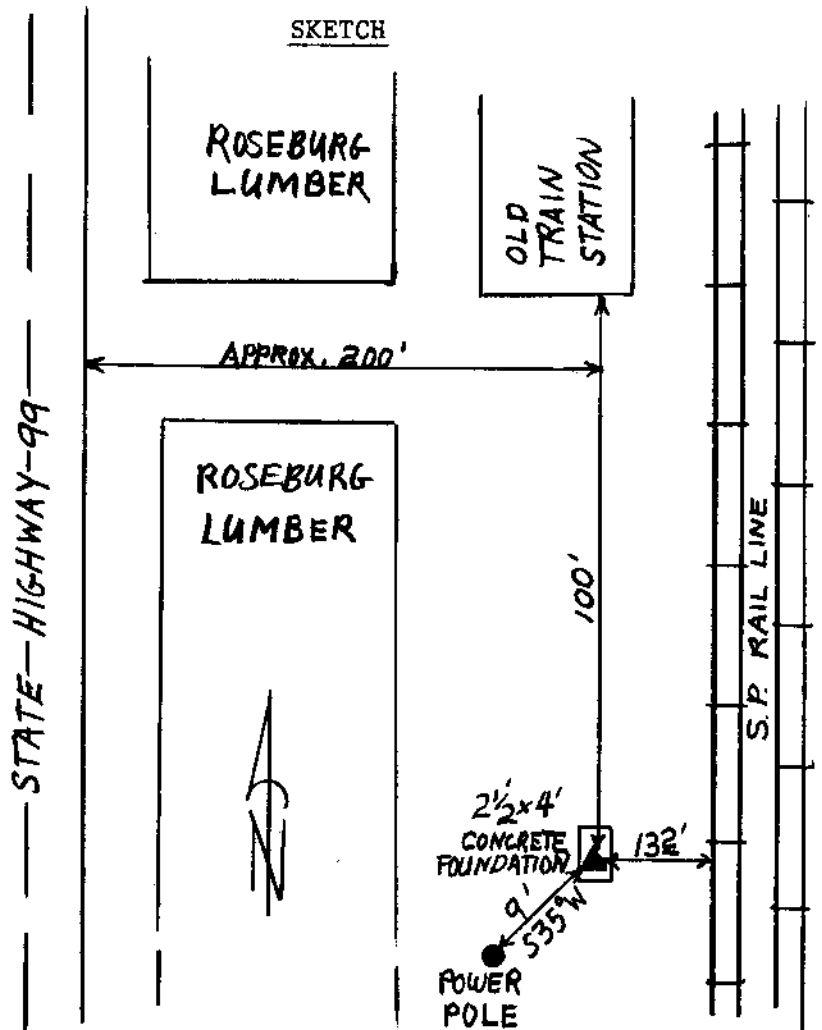

Reference Marks:

Note: For further information, contact the Douglas County Surveyor's Office, Room 205 Douglas County Justice Building, Roseburg, OR 97470. Phone 440-4278. Douglas County residents outside the Roseburg calling area, dial toll free 1-800-452-0991.