

OFFICE OF THE  
DOUGLAS COUNTY SURVEYOR

Station: MORGAN \* **DISTURBED** \*  
 Date Set: 1972  
 Set By (Agency): GARRET LS #0544  
 DCSD Designation: M-054  
 Date Recovered: 10-22-1984  
 Recovered By: RS SJF  
 Date Recovered: \_\_\_\_\_  
 Recovered By: \_\_\_\_\_  
 Date Recovered: \_\_\_\_\_  
 Recovered By: \_\_\_\_\_

T28W R6W Sec. 16

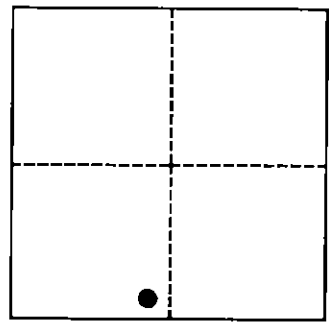
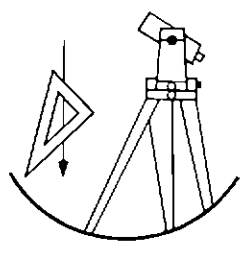

VERTICAL CONTROL

NGVD 29 Elevation: 650.00 FEET NAVD 88 Elevation: \_\_\_\_\_ METERS  
 NGS Line # \_\_\_\_\_ USGS LINE # \_\_\_\_\_ OSHD Line # \_\_\_\_\_ FILE # \_\_\_\_\_  
 Precision: 3RD ORDER Agency: BENTZ LS #0839 Proj: \_\_\_\_\_ Date: 1972

HORIZONTAL CONTROL

O.C.S. 27 Y(Northing): 546,113.72 O.C.S. 83 Y(Northing): 546,078.59  
 (South Zone) X(Easting): 1,222,189.75 (South Zone) X(Easting): 4,143,148.04  
 Precision: 1/25,000 Agency: DCSO Proj: 2005 CS#56/9 Date: 1972  
 Approx. O.C.S. 27 Geographic Position: Latitude: 43°07'41" Longitude: 123°24'52"  
 Approx. O.C.S. 83 Geographic Position: Latitude: 43°07'40" Longitude: 123°24'56"

**NOTE \* MON. IS DISTURBED \***

Description: A DCSD disk stamped "MORGAN 1972" set on an iron pipe protruding 2 inches above the ground.

To reach: From the intersection of State Hwy 99 and Lookingglass Rd. (Co. Rd. #107) in T28S R6W Sec16 proceed westerly along Lookingglass Rd. approx. 0.3 miles to monument approx. 150 feet on right.

\*NOTE: MONUMENT IS IN PLOWED FIELD AND HAS BEEN DISTURBED (CAP SHOWS SCUFF MARKS)

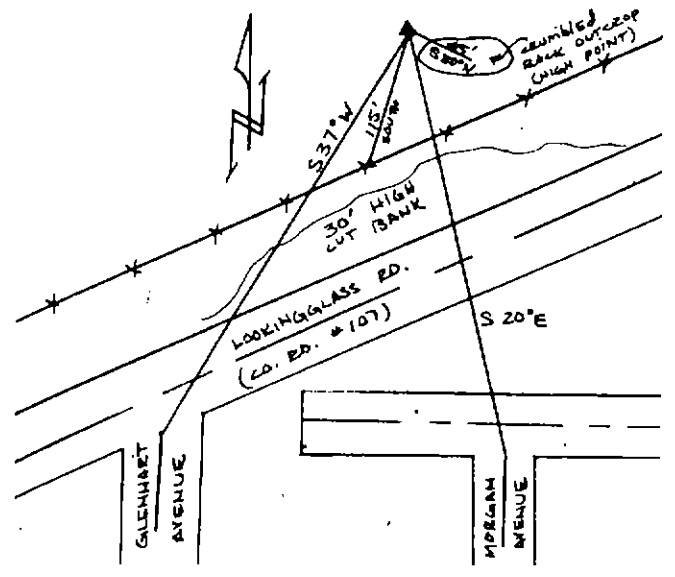

Note: For further information contact the Douglas County Surveyors Office, Room 205 Douglas County Justice Building, Roseburg, OR 97470. Phone 440-4272. Douglas County Residents outside Roseburg calling area, dial toll free 1-800-477-0991.