

OFFICE OF THE
DOUGLAS COUNTY SURVEYOR

Station: FRITZ T 28 S, R5 1/2 E, Sec 20
 Set By (Agency): 1974
 Date Set: DCSO
 Recovered By RWS,SJF
 Date Recovered 5/23/88
 Recovered By _____
 Date Recovered _____
 Recovered By _____
 Date Recovered _____

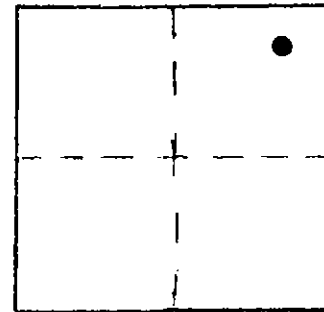

F-027 288 3 1/2 E 20
FRITZ 1974

440 340125.09 4482524.12
88 43° 8' 18" 122° 5' 33"

VERTICAL CONTROL

Elevation: 5,186.800 ft. NGS Line # _____ USGS Line # _____ OSHD Line # _____
 Precision: 2nd order Agency: DCSO Proj. # 2004-8, CS57/23 Date: 1974

HORIZONTAL CONTROL

South Zone State Plane Coordinates: Y(Northing) 540,164.18 X(Easting) 1,561,662.73
 Precision: 1/50,000 Agency: DCSO Proj. # 2004-8, CS57/23 Date: 1975
 Approximate Geographic Position: Latitude 43°08'13" Longitude 122°08'33"

DESCRIPTION and TO REACH

Monument is a standard DCSO disk set in top of an 8 inch o.d. concrete filled concrete belltile set flush with ground. Monument is stamped "FRITZ 1974".

TO REACH:

From the intersection of State Highway 230 and USFS road 6592 in T28S,R5 1/2E,Sec.21 proceed northerly along USFS road 6592 approximately 0.7 miles to the intersection with USFS road 4795, proceed westerly along USFS road 4795 approximately 0.4 miles to the entrance of the USFS Diamond Lake southshore picnic grounds. The monument lies approximately 135 feet east from a concrete and wood dock, and 145 feet northerly from picnic area rest rooms.

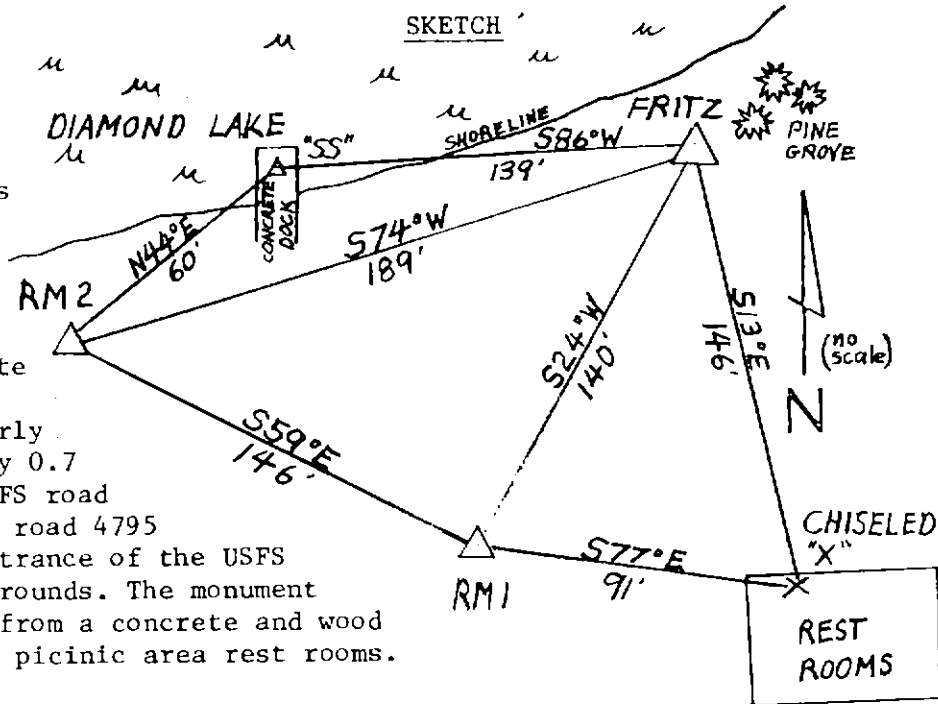

REFERENCE MARKS:

Two standard DCSO disks set in tops of two 8 inch o.d. concrete filled concrete belltiles set flush with ground. One marked "FRITZ R.M. 1" bears S25°43'56"W, 139.69 ft. (grid)(El. 5190.138 ft.) and one marked "FRITZ R.M. 2" bears S76°01'19"W, 188.57 ft. (grid)(El. 5185.890 ft.).

A 1/4 inch diameter brass rod set flush with surface at water end of concrete dock bears S87°50'35"W, 138.96 ft. (grid).

A 3 inch wide "X" chiseled in the exterior concrete floor near NW corner of rest room structure bears S11°10'20"E, 146.22 ft. (grid).

Note: For further information, contact the Douglas County Surveyor's Office, Room 205 Douglas County Justice Building, Roseburg, OR 97470. Phone 440-4278. Douglas County residents outside the Roseburg calling area, dial toll free 1-800-452-0991.