

OFFICE OF THE
DOUGLAS COUNTY SURVEYOR

Station: A-22

T 28 S, R 5½ E, Sec 20

Set By (Agency): B.P.R.

Date Set: Unknown

Recovered By FLI (DCSO)

Date Recovered 6-28-84

Recovered By _____

Date Recovered _____

Recovered By _____

Date Recovered _____

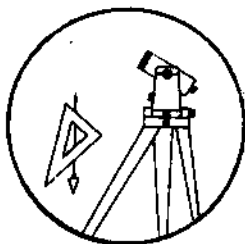
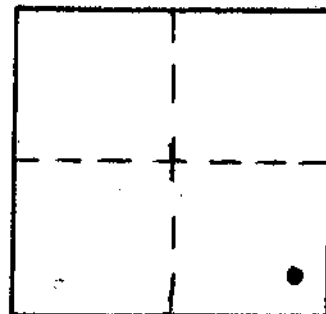

A-009

VERTICAL CONTROL **NGVD29**

Elevation: 5201.541 NGS Line # 128 USGS Line # _____ OSHD Line # _____

Precision: 2nd Agency: USC & GS Proj. # 2004-8 CS 57/23 Date: 1957

HORIZONTAL CONTROL

South Zone State Plane Coordinates: Y(Northing) _____ X(Easting) _____

Precision: _____ Agency: _____ Proj. # _____ Date: _____

Approximate Geographic Position: Latitude _____ Longitude _____

DESCRIPTION and TO REACH

SKETCH

S.E. of old Hwy 230,
0.5 mi. S.W. of the junction
of old Hwy 138 and old Hwy
230.

B.C. in concrete post
65 ft. east of pavement
edge.

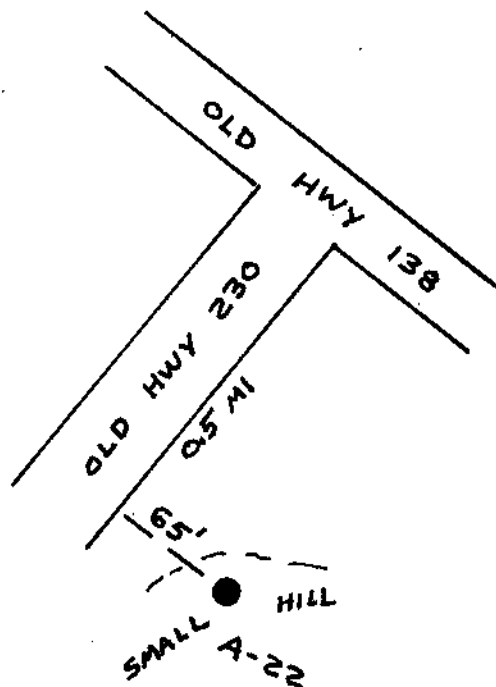

Reference Marks:

Note: For further information, contact the Douglas County Surveyor's Office, Room 205 Douglas County Justice Building, Roseburg, OR 97470. Phone 440-4278. Douglas County residents outside the Roseburg calling area, dial toll free 1-800-452-0991.