

OFFICE OF THE  
DOUGLAS COUNTY SURVEYOR

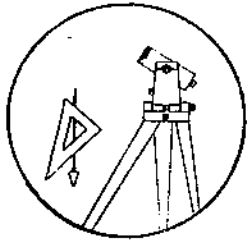

Station:     I 9     T 30 S, R 6 W , Sec 32  
 Set By (Agency): USGS  
 Date Set: 1903  
 Recovered By RWS,SJF  
 Date Recovered 11/7/88  
 Recovered By \_\_\_\_\_  
 Date Recovered \_\_\_\_\_  
 Recovered By \_\_\_\_\_  
 Date Recovered \_\_\_\_\_

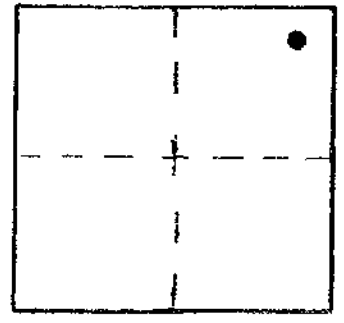

VERTICAL CONTROL

Elevation: 722.663 NGS Line # 6 USGS Line # \_\_\_\_\_ OSHD Line # \_\_\_\_\_  
 Precision: 1st Agency: USC&GS Proj. # 2013 Date: 1957

HORIZONTAL CONTROL

South Zone State Plane Coordinates: Y(Northing) \_\_\_\_\_ X(Easting) \_\_\_\_\_  
 Precision: \_\_\_\_\_ Agency: \_\_\_\_\_ Proj. # \_\_\_\_\_ Date: \_\_\_\_\_  
 Approximate Geographic Position: Latitude \_\_\_\_\_ Longitude \_\_\_\_\_

DESCRIPTION and TO REACH

A 3 3/4 in. dia. USGS disk stamped "721 B 1903"  
 set in a 1 ft. square topped concrete post  
 protruding 9 in. above ground.

TO REACH:

From the intersection of Cow Creek Rd. (Co.Rd.#39)  
 and Riddle By-Pass Rd. (Co.Rd. #263) in T30S,R6W,  
 Sec.23, proceed southwesterly along Cow Creek Rd.  
 approximately 2.4 miles to Nickel Mountain Rd. and  
 S.P.R.R. tracks crossing County Rd., proceed westerly  
 along S.P.R.R. tracks approximately 0.9 miles to  
 monument on right.

SKETCH

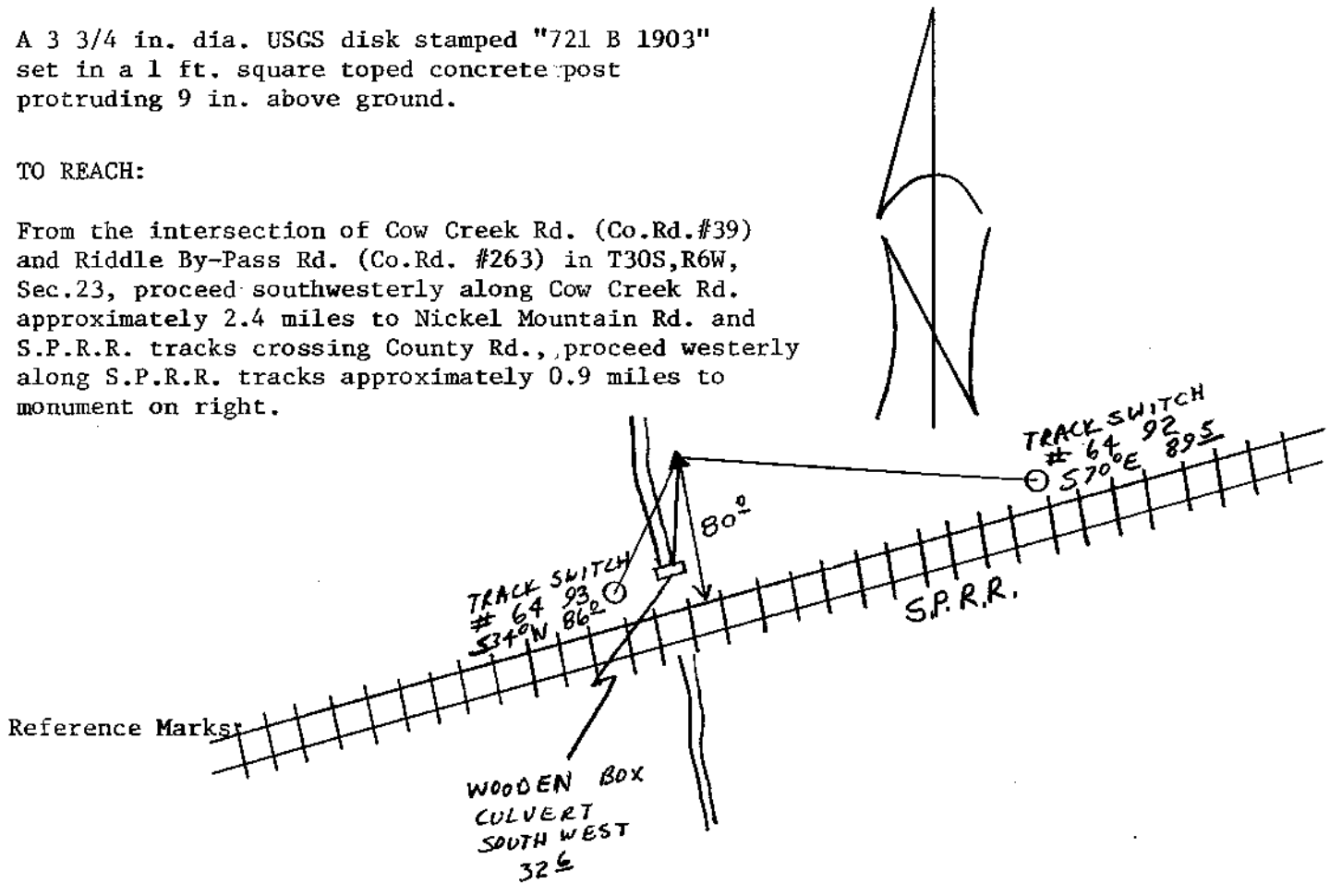

Note: For further information, contact the Douglas County Surveyor's Office, Room 205  
 Douglas County Justice Building, Roseburg, OR 97470. Phone 440-4278. Douglas  
 County residents outside the Roseburg calling area, dial toll free 1-800-452-0991.