

OFFICE OF THE  
DOUGLAS COUNTY SURVEYOR

Station: ED T 27 S, R 6 E. , Sec 29  
 Set By (Agency): DCSO  
 Date Set: 1974  
 Recovered By FLI (DCSO)  
 Date Recovered 6-15-84  
 Recovered By \_\_\_\_\_  
 Date Recovered \_\_\_\_\_  
 Recovered By \_\_\_\_\_  
 Date Recovered \_\_\_\_\_

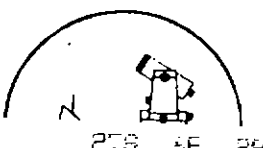

2-011  
 51  
 NAD 83 561697.61 485087.53  
 43°11'46" 122°08'10"

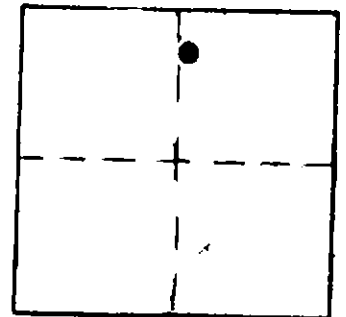

VERTICAL CONTROL

Elevation: 5290.572 NGS Line # \_\_\_\_\_ USGS Line # \_\_\_\_\_ OSHD Line # \_\_\_\_\_  
 Precision: 2nd Agency: DCSO Proj. # 2004-8 CS57/23 Date: 1974

HORIZONTAL CONTROL

South Zone State Plane Coordinates: Y(Northing) 561,735.43 X(Easting) 1,564,075.90  
 Precision: 1/25,000 Agency: DCSO Proj. # 2004-8 CS57/23 Date: 1975  
 Approximate Geographic Position: Latitude 43°11'47" Longitude 122°08'06"

DESCRIPTION and TO REACH

0.3 miles S.S.W. of  
 intersection of old Hwy 138  
 with new Hwy 138 (1.5 mi.  
 from station to Diamond Lake  
 Lodge Entrance).  
 B.C. set in 6" bell tile on  
 west side of old Hwy 138.

SKETCH

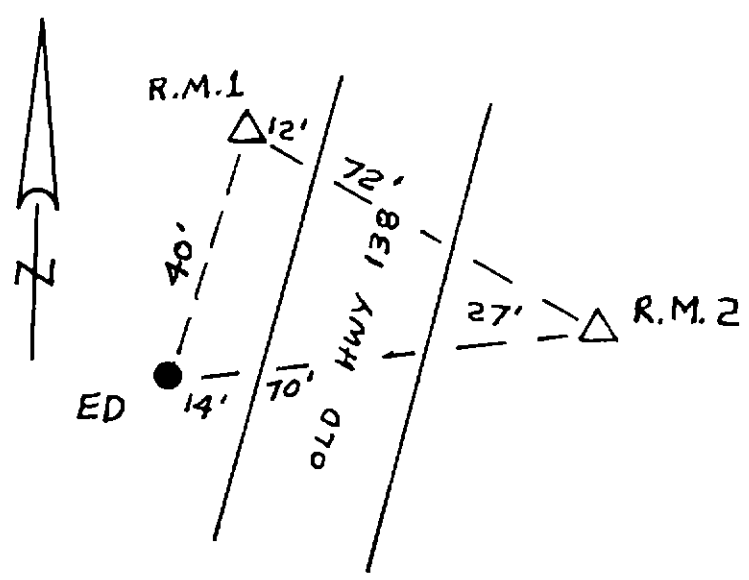

Reference Marks:	ED R.M. 1	B.C. in 6" bell tile (El. 5291.430) 561,772.42 1,564,090.08
	ED R.M. 1	B.C. in 6" bell tile (El. 5290.032) 561,726.80 1,564,145.47

Note: For further information, contact the Douglas County Surveyor's Office, Room 205 Douglas County Justice Building, Roseburg, OR 97470. Phone 440-4278. Douglas County residents outside the Roseburg calling area, dial toll free 1-800-452-0991.