

OFFICE OF THE
DOUGLAS COUNTY SURVEYOR

Station: V-480

T 27 S, R 6E, Sec 20

Set By (Agency): USC & GS

Date Set: 1941

Recovered By FLI (DCSO)

Date Recovered 6-15-84

Recovered By _____

Date Recovered _____

Recovered By _____

Date Recovered _____

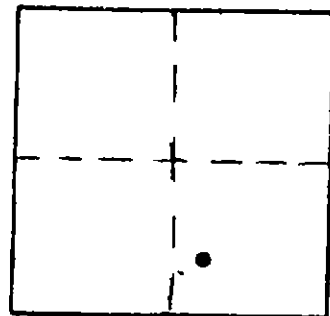

v-007
v 480
27S 6E 20

NAD 563661.16 4495801.74
SP 43°12' 51" 122° 5' 0"

VERTICAL CONTROL

Elevation: 5258.648 NGS Line # 94 USGS Line # _____ OSHD Line # _____

Precision: 1st Agency: USC & GS Proj. # 2004-8 Date: 1948

HORIZONTAL CONTROL

South Zone State Plane Coordinates: Y(Northing) 563,698.96 X(Easting) 1,564,840.07

Precision: 1/10,000 Agency: DCSO Proj. # 2008-1 CS62/23 Date: 1984

Approximate Geographic Position: Latitude 43°12'06" Longitude 122°07'56"

DESCRIPTION and TO REACH

SKETCH

2.5 mi. south of Cinnamon
Butte Road along east
side of Hwy 138.

B.C. set in 2 ft. x 3 ft.
boulder 0.2 ft. above ground.

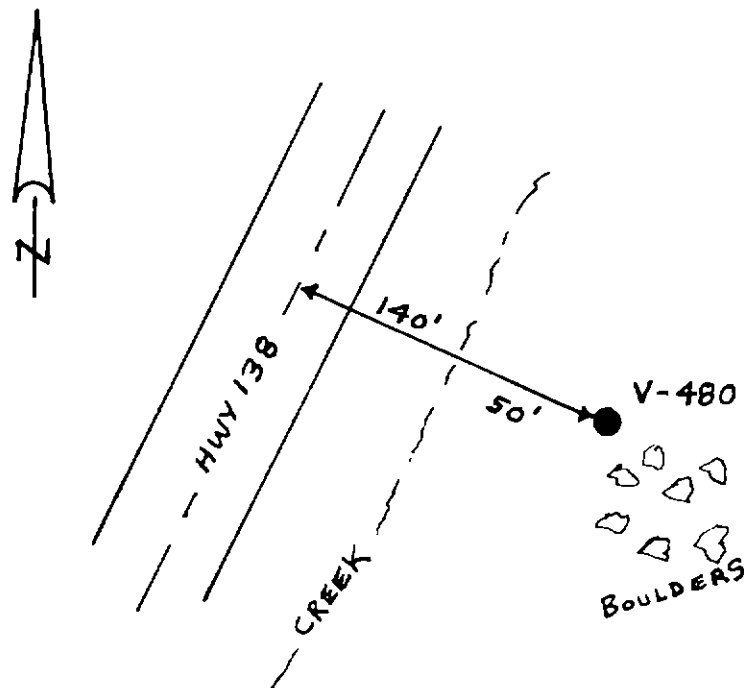

Reference Marks:

Note: For further information, contact the Douglas County Surveyor's Office, Room 205 Douglas County Justice Building, Roseburg, OR 97470. Phone 440-4278. Douglas County residents outside the Roseburg calling area, dial toll free 1-800-452-0991.