

OFFICE OF THE
DOUGLAS COUNTY SURVEYOR

Station: MR.ED T 27 S, R 6 W, Sec 9

Set By (Agency): DCSO

Date Set: 1989

Recovered By RWS, SJF

Date Recovered 7/10/89

Recovered By _____

Date Recovered _____

Recovered By _____

Date Recovered _____

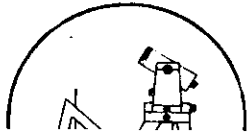
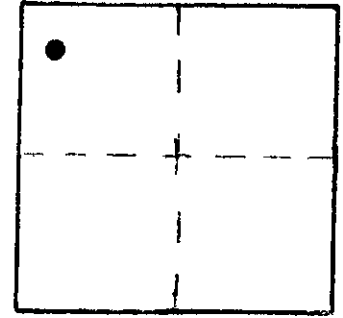

M-070
MR ED 27S 6W 9

NAD 587563.29 4141932.86
83 43°14'30" 123°25'32"

VERTICAL CONTROL **NGVD 29**

Elevation: 408.619 NGS Line # _____ USGS Line # _____ OSHD Line # _____

Precision: 2nd Agency: DCSO Proj. # 2007 Date: 1990

HORIZONTAL CONTROL **OCS 27**

South Zone State Plane Coordinates: Y(Northing) 587,598.35 X(Easting) 1,220,974.49

Precision: 1/25,000 Agency: DCSO Proj. # GPS 27/83 Date: 1991

Approximate Geographic Position: Latitude _____ Longitude _____

DESCRIPTION and TO REACH

SKETCH

A DCSO disk stamped "MR.ED 1989" set in an 8 in. dia. by 42 in. long concrete filled belltile, flush with ground.

From the intersection of Melrose Rd. (Co.Rd.13) and Old Melrose Rd.(Co.Rd.#13b) in T27S,R6W, Sec.9, proceed westerly along Co.Rd.#13 0.2 miles to monument on left.

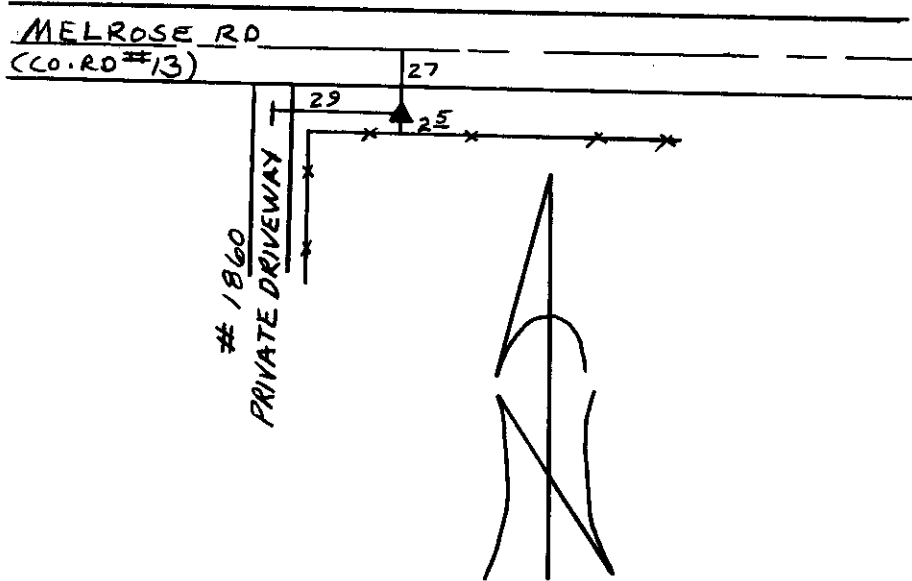

Reference Marks:

Note: For further information, contact the Douglas County Surveyor's Office, Room 205 Douglas County Justice Building, Roseburg, OR 97470. Phone 440-4278. Douglas County residents outside the Roseburg calling area, dial toll free 1-800-452-0991.