

OFFICE OF THE
DOUGLAS COUNTY SURVEYOR

M-068

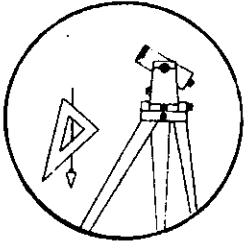

Station: MONREAN T 27 S, R 6 W, Sec 9

Set By (Agency): State Highway Dept.

Date Set: ?

Recovered By RWS, SJF

Date Recovered 7/10/89

Recovered By _____

Date Recovered _____

Recovered By _____

Date Recovered _____

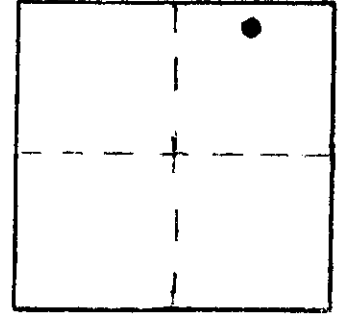

VERTICAL CONTROL **NGVD 29**

Elevation: 418.921 NGS Line # _____ USGS Line # _____ OSHD Line # _____

Precision: 2nd Agency: DCSO Proj. # 2007 Date: 1990

HORIZONTAL CONTROL

South Zone State Plane Coordinates: Y(Northing) _____ X(Easting) _____

Precision: _____ Agency: _____ Proj. # _____ Date: _____

Approximate Geographic Position: Latitude _____ Longitude _____

DESCRIPTION and TO REACH

SKETCH

A State Highway disk stamped "MONREAN 1989"
set flush in southerly curb at west end of
concrete bridge over South Umpqua river.

From the intersection of Old Melrose Rd.
(Co.Rd.#13b) and Melrose Rd. (Co.Rd.#167)
in T27S,R6W,Sec.9, proceed easterly along
Melrose Rd. approx. 0.45 miles to monument
on right.

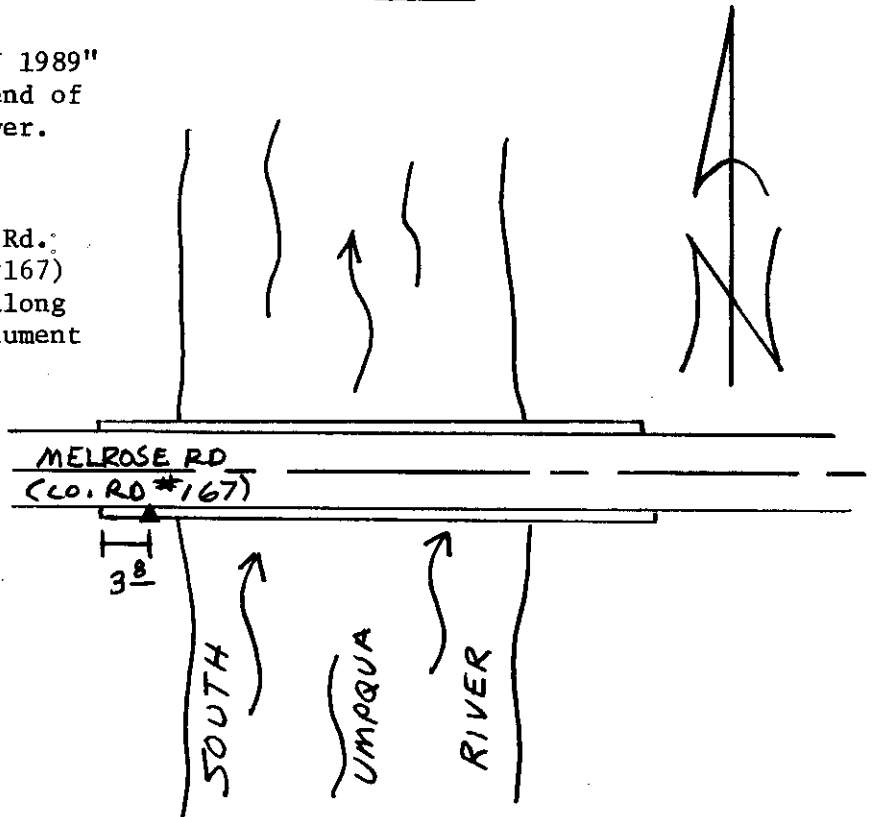

Reference Marks:

Note: For further information, contact the Douglas County Surveyor's Office, Room 205
Douglas County Justice Building, Roseburg, OR 97470. Phone 440-4278. Douglas
County residents outside the Roseburg calling area, dial toll free 1-800-452-0991.