

OFFICE OF THE
DOUGLAS COUNTY SURVEYOR

Station: 49-3
 Set By (Agency): CITY (RSBG)
 Date Set: ?
 Recovered By KR, TP
 Date Recovered 5/82
 Recovered By 10/98
 Date Recovered _____
 Recovered By _____
 Date Recovered _____

T 27 S, R 5 W, Sec 18



#-016
49-3

27S 5W 18

NAD 578343.31 4163447.46
 83 43°13' 6" 123°20'37"

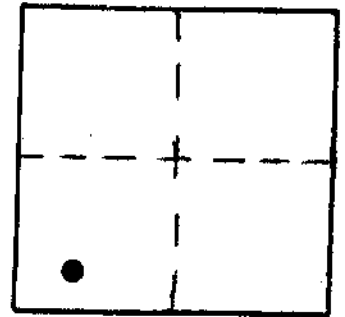

VERTICAL CONTROL

Elevation: 520²⁵ NGS Line # _____ USGS Line # _____ OSHD Line # _____
 Precision: 3rd Agency: DCSO Proj. # 2007 Date: 1998

HORIZONTAL CONTROL NAD 27

South Zone State Plane Coordinates: Y(Northing) 578,378.51 X(Easting) 1,242,489.16
 Precision: 1/20,000 Agency: DCSO Proj. # 2005-2 Date: 1983
 Approximate Geographic Position: Latitude 43°13'06" Longitude 123°20'33"

DESCRIPTION and TO REACH

SKETCH

DESCRIPTION:

A disk stamped "49-3" set flush in concrete curbing.

TO REACH:

Go to intersection of NE Stephens St. and NE Shambrook Ave.

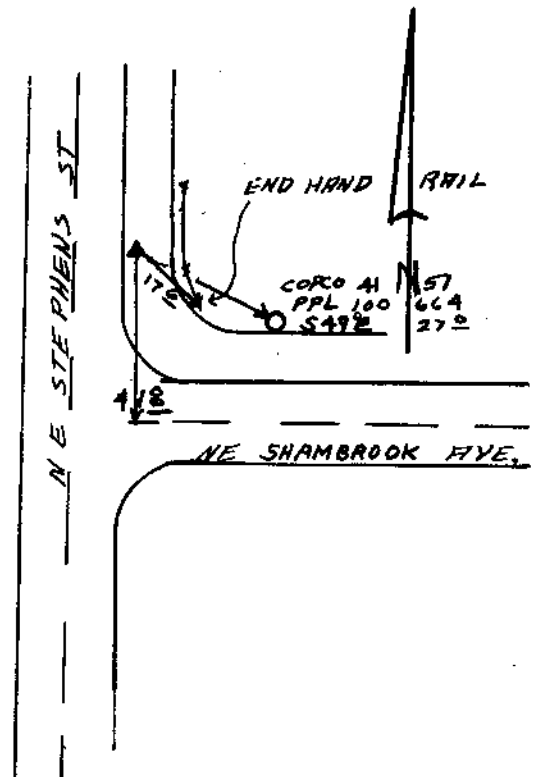

Reference Marks:

Note: For further information, contact the Douglas County Surveyor's Office, Room 205 Douglas County Justice Building, Roseburg, OR 97470. Phone 440-4278. Douglas County residents outside the Roseburg calling area, dial toll free 1-800-452-0991.