

OFFICE OF THE  
DOUGLAS COUNTY SURVEYOR

u-132  
UW-11

265 7W 11

NAD 620011.01 4125150.33  
83 43°19'44" 123°29'34"

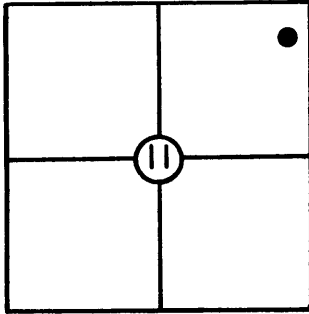

T 26 S, R 7W, Sec. 11

Station: UW-11

Set By (Agency): DCSO

Date: 1974

VERTICAL CONTROL

**NGVD 29**  
Elevation: 582.762 NGS(USC&GS) Line # \_\_\_\_\_ USGS Line # \_\_\_\_\_

Order  
Of Precision 2nd Agency: DCSO Proj. #: 2007 Date: 1991

HORIZONTAL CONTROL

**OCS 27**  
Oregon State Plane Coordinates: Y(Northing) 620,046.03 X(Easting) 1,204,191.12  
(South Zone)

Order  
Of Precision 1/25,000 Agency: DCSO Proj. #: 2006 Date: 1974

Approximate Geographic Position: Latitude= \_\_\_\_\_ Longitude= \_\_\_\_\_

DESCRIPTION: Station is a brass cap cemented  
in 6" belltile buried flush on a cut-bank E.  
of rd. To reach from Melrose Store proceed  
N'thly on Co. Rd. # 13 7.6 mi. to station.

\_\_\_\_\_  
\_\_\_\_\_  
\_\_\_\_\_  
\_\_\_\_\_  
\_\_\_\_\_

VICINITY: Melrose-Umpqua Rd. (Co. Rd. #13)

Approx. 7 1/2 mi. N. of Melrose.

SKETCH

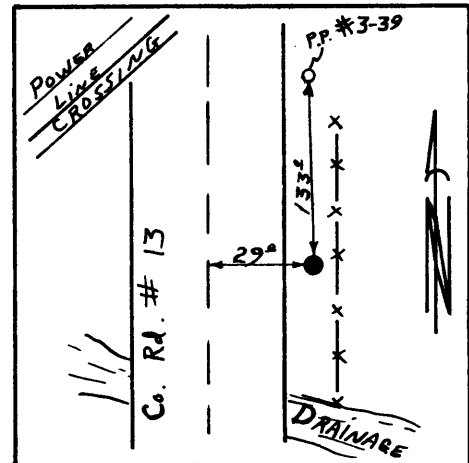

NOTE: For Possible Further Information On This Station, Please Contact The Douglas County Surveyors Office, Rm. 205 Douglas County Justice Bldg., Roseburg, OR. 97470 Phone 672-3311 Ext. 272. Douglas County residents outside the Roseburg calling area dial toll free 1-800-452-0991.