

OFFICE OF THE
DOUGLAS COUNTY SURVEYOR

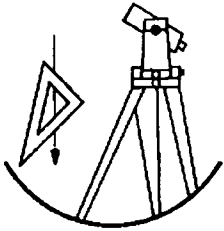

Station: ANDRECHT
 Date Set: 1993
 Set By (Agency): RLS 866
 DCSO Designation: A-084
 Date Recovered: 6-21-1993
 Recovered By: RWS SJF
 Date Recovered: _____
 Recovered By: _____
 Date Recovered: _____
 Recovered By: _____

T26S R6W Sec. 27

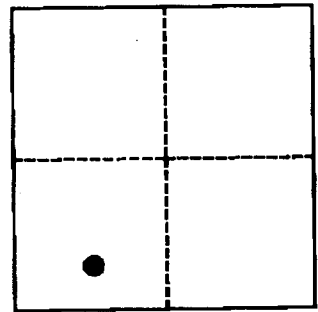

CORPCOM6 NAVD 88

VERTICAL CONTROL

NGVD 29 Elevation: 411.26 FEET NAVD 88 Elevation: 414.72 FT-METERS
 NGS Line # _____ USGS LINE # _____ OSHD Line # _____ FILE # _____
 Precision: 3RD ORDER Agency: RLS 866 Proj: 1993-0039 Date: 1993

HORIZONTAL CONTROL

O.C.S. 27 Y(Northing): _____ O.C.S. 83 Y(Northing): _____
 (South Zone) X(Easting): _____ (South Zone) X(Easting): _____
 Precision: _____ Agency: _____ Proj: _____ Date: _____
 Approx. O.C.S. 27 Geographic Position: Latitude: _____ Longitude: _____
 Approx. O.C.S. 83 Geographic Position: Latitude: _____ Longitude: _____

Found: A 2 - 3/8 inch diameter brass cap set in a 6 inch diameter concrete filled plastic pipe, flush with ground.

To reach: From the intersection of Cherokee Ave. (Co. Rd. #334A) and Garden Valley Rd. (Co. Rd. #6) in T26S R6W Sec28 proceed easterly along Cherokee Ave. approx. 0.3 miles to end, proceed southerly along private road approx. 0.1 miles to private road on left proceed easterly approx. 170 feet to monument on right.

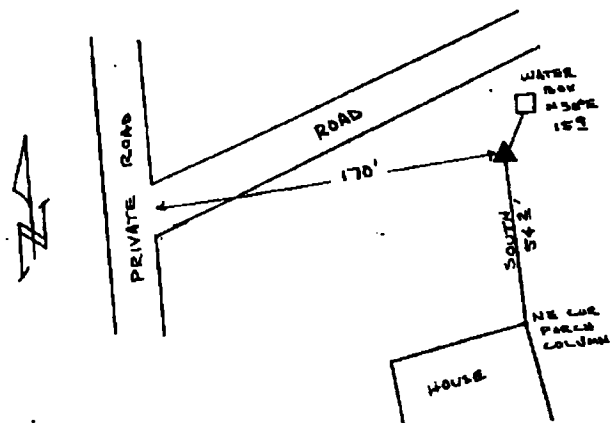

Note: For further information contact the Douglas County Surveyors Office, Room 205 Douglas County Justice Building, Roseburg, OR 97470. Phone 440-4272. Douglas County Residents outside Roseburg calling area, dial toll free 1-800-477-0991.