

OFFICE OF THE
DOUGLAS COUNTY SURVEYOR

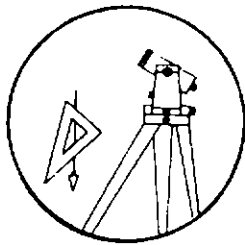

Station: LAKE
Set By (Agency): O.S.H.D.
Date Set: UNKNOWN
Recovered By FLI (DCSO)
Date Recovered 7/23/84
Recovered By _____
Date Recovered _____
Recovered By _____
Date Recovered _____

UNS
T 26 S, R 5E , Sec 36

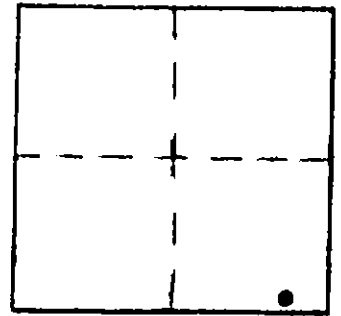

VERTICAL CONTROL

Elevation: 4504.926 NGS Line # _____ USGS Line # _____ OSHD Line # _____
Precision: 2nd Agency: DCSO Proj. # 2008-1 CS62/23 Date: July 1984

HORIZONTAL CONTROL

South Zone State Plane Coordinates: Y(Northing) _____ X(Easting) _____
Precision: _____ Agency: _____ Proj. # _____ Date: _____
Approximate Geographic Position: Latitude _____ Longitude _____

DESCRIPTION and TO REACH

SKETCH

Along Highway 138, 0.1 mile east of Lake Creek, and 0.3 mile east of Lemolo Lake Junction.

Unstamped brass cap in concrete post, 35 ft. south of Highway 138, 38 ft. east of edge of old gravel road.

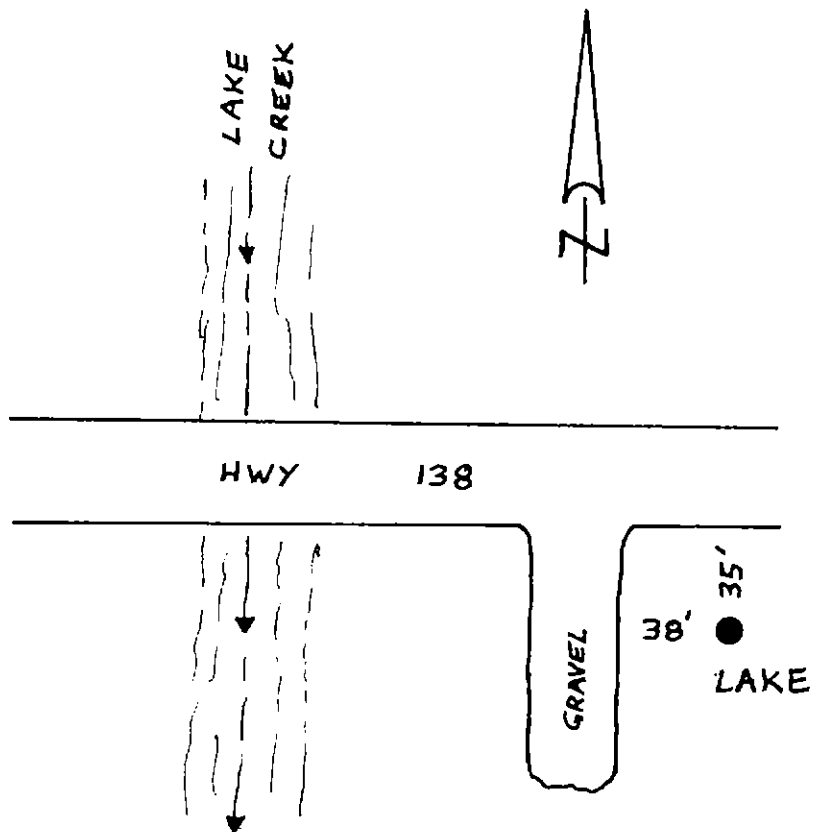

Reference Marks:

Note: For further information, contact the Douglas County Surveyor's Office, Room 205 Douglas County Justice Building, Roseburg, OR 97470. Phone 440-4278. Douglas County residents outside the Roseburg calling area, dial toll free 1-800-452-0991.