

OFFICE OF THE
DOUGLAS COUNTY SURVEYOR

Station: NU 11 T 26 S, R 5 W, Sec 21

Set By (Agency): DCSO

Date Set: 1972

Recovered By RWS,SJF

Date Recovered 9/16/85

Recovered By _____

Date Recovered _____

Recovered By _____

Date Recovered _____

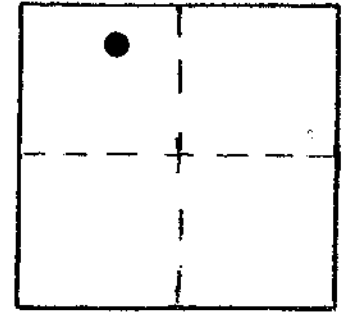

n-039 26S 5W 21
NU 11

NAD 607358.53 4176564.69
83 43°17'57" 123°17'53"

VERTICAL CONTROL

Elevation: 539.482 NGS Line # _____ USGS Line # _____ OSHD Line # _____

Precision: 2nd Agency: DCSO Proj. # 2006 Date: 1973

HORIZONTAL CONTROL

South Zone State Plane Coordinates: Y(Northing) 607,393.62 X(Easting) 1,255,605.66

Precision: 1/25,000 Agency: DCSO Proj. # 2006 Date: 1973

Approximate Geographic Position: Latitude 43°17'57" Longitude 123°17'49"

DESCRIPTION and TO REACH

SKETCH

A DCSO disk stamped "NU 11 1972" set in an 8 in. diam. concrete filled concrete belltile protruding 10 in. above ground.

TO REACH:

From the intersection of State Highway 99 and Page Rd. (Co.Rd.#115A) in T26S,R6W,Sec.25, proceed easterly along Page Rd. approx. 3.9 miles to a point 100 ft. westerly of the end of County maintained Rd. Monument lies on left.

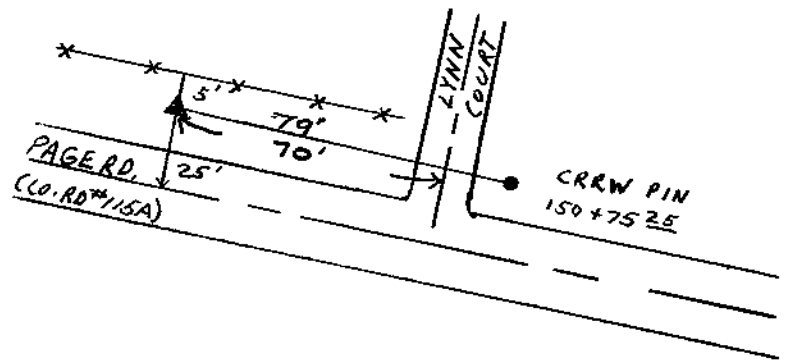

Reference Marks:

Note: For further information, contact the Douglas County Surveyor's Office, Room 205 Douglas County Justice Building, Roseburg, OR 97470. Phone 440-4278. Douglas County residents outside the Roseburg calling area, dial toll free 1-800-452-0991.