

OFFICE OF THE  
DOUGLAS COUNTY SURVEYOR

Station: NU 12 T 26 S, R 5 W, Sec 10

Set By (Agency): DCSO

Date Set: 1972

Recovered By RWS, SJF

Date Recovered 8/9/85

Recovered By \_\_\_\_\_

Date Recovered \_\_\_\_\_

Recovered By \_\_\_\_\_

Date Recovered \_\_\_\_\_

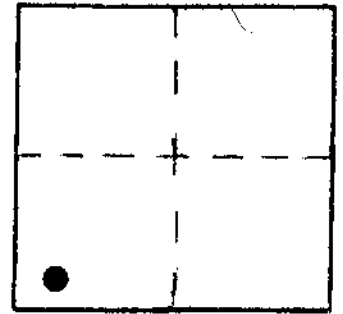

n-040  
NU 12

265 5W 10

NAD 613938.01 4180706.70  
83 43°19' 3" 123°17' 0"

VERTICAL CONTROL NGVD 29

Elevation: 580.547 NGS Line # \_\_\_\_\_ USGS Line # \_\_\_\_\_ OSHD Line # \_\_\_\_\_

Precision: 2nd Agency: DCSO Proj. # 2006 Date: 1972

HORIZONTAL CONTROL OCS 27

South Zone State Plane Coordinates: Y(Northing) 613,973.12 X(Easting) 1,259,747.64

Precision: 1/25,000 Agency: DCSO Proj. # 2006 Date: 1972

Approximate Geographic Position: Latitude 43°19'03" Longitude 123°16'56"

DESCRIPTION and TO REACH

SKETCH

A DCSO disk stamped "NU 12 1972" set in a concrete filled belltile protruding 1 ft. above ground.

TO REACH:

From the intersection of State Hwy 99 and North Bank Rd. (Co.Rd.#200) in T26S,R5W,Sec.18, proceed easterly along North Bank Rd. 3.75 miles to monument on right.

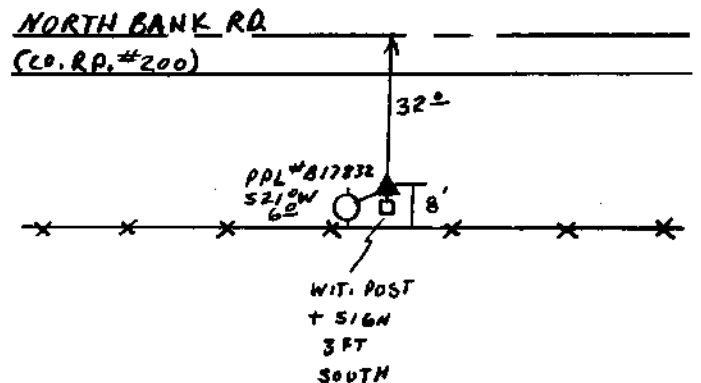

Reference Marks:

Note: For further information, contact the Douglas County Surveyor's Office, Room 205 Douglas County Justice Building, Roseburg, OR 97470. Phone 440-4278. Douglas County residents outside the Roseburg calling area, dial toll free 1-800-452-0991.