

DOUGLAS COUNTY SURVEYOR

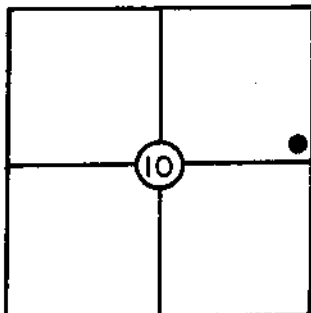

C-120

T 26 S, R 3 W, Sec. 10

Station: CURRY 1980

Set By (Agency): GRUBB (LS# 397)

Date: 1980

VERTICAL CONTROL

NGVD 29

Elevation: 768.22 NGS(USC&GS) Line # _____ USGS Line # _____

Order Of Precision 3rd Agency: GRUBB #397 Proj. #: MLP M# 85-58 Date: 1980

HORIZONTAL CONTROL

Oregon State Plane Coordinates: Y(Northing) _____ X(Easting) _____
(South Zone)

Order Of Precision _____ Agency: _____ Proj. #: _____ Date: _____

Approximate Geographic Position: Latitude= _____ Longitude= _____

DESCRIPTION: From the bridge at Lone Rock
proceed Easterly along County Rd. #4 (N.
Umpqua Hwy.) approx. 2.5 miles to Helms
Rd., on the North side of County Rd. #4;
the monument is approx. 210 ft. N. of Co.
Rd. #4 along Helms Rd. and approx. 260 ft
Easterly of Helms Rd. Monument is a brass
cap set in conc. stamped "CURRY 1980 elev.
768.22 PLS 397".

VICINITY: Idlelyd Area

SKETCH

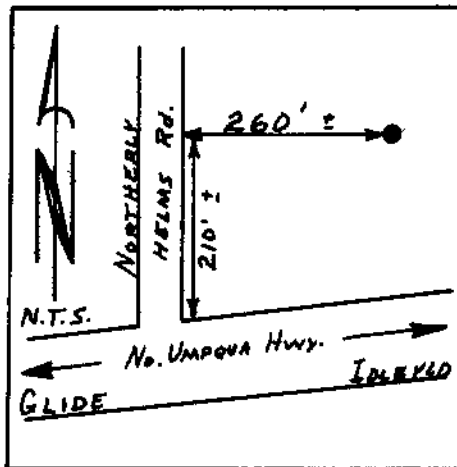

NOTE: For Possible Further Information On This Station, Please Contact The Douglas County Surveyors Office, Rm. 205 Douglas County Justice Bldg., Roseburg, OR. 97470 Phone 672-3311 Ext. 272. Douglas County residents outside the Roseburg calling area dial toll free 1-800-452-0991.