

OFFICE OF THE
DOUGLAS COUNTY SURVEYOR

p-042
PONY

355 6W 12

NAD	646319.26	4140325.55
BE	43°24' 16"	123°21' 51"

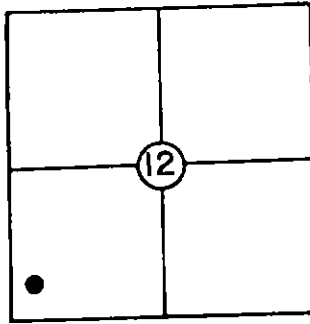

T 25 S, R 6 W, Sec. 12

Station: PONY

Set By (Agency): DCSO

Date: 1980

VERTICAL CONTROL

Elevation: 396.338 NGS(USC&GS) Line # _____ USGS Line # _____

Order (Calapooya)
Of Precision 2nd Class I Agency: DCSO Proj. #: 2006 Date: 1981

HORIZONTAL CONTROL

Oregon State Plane Coordinates: Y(Northing) 646,353.82 X(Easting) 1,239,366.42
(South Zone)

Order (Calapooya)
Of Precision 1/25,000 Agency: DCSO Proj. #: 2006 Date: 1981

Approximate Geographic Position: Latitude= 43° 24' 16" Longitude= 123° 21' 46"

DESCRIPTION: A standard DCSO brass cap set
in conc. filled belltile protruding 4" above
ground. Stamped "PONY 1980" 29 ft. from
centerline of old Hwy 225 and 75 ft. from
centerline of Green Valley Rd. See sketch.
TO REACH: From intersection of Hwy 138 and
old Hwy 225 go approx. 2.5 mi. on Hwy 225
to intersection of old Hwy 225 and Green
Valley Rd. Sta. on rt, witness sign 6 ft.
South of station in fence.
VICINITY: 1 mi. from intersection of Hwy 138
and old Hwy 225 on old Hwy 225.

SKETCH

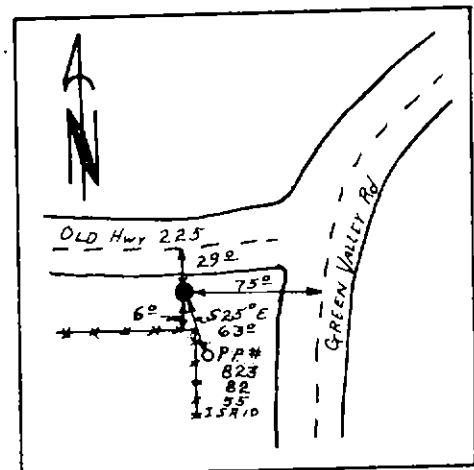

NOTE: For Possible Further Information On This Station, Please Contact The Douglas County Surveyors Office, Rm. 205 Douglas County Justice Bldg., Roseburg, OR. 97470 Phone 672-3311 Ext. 272. Douglas County residents outside the Roseburg calling area dial toll free 1-800-452-0991.