

OFFICE OF THE
DOUGLAS COUNTY SURVEYOR

Station: Z 739
 Date Set: 1987
 Set By (Agency): NGS
 DCSO Designation: Z-013
 Date Recovered: 8-93
 Recovered By: SJF-RWS
 Date Recovered: _____
 Recovered By: _____
 Date Recovered: _____
 Recovered By: _____

T25S R5W Sec. 31

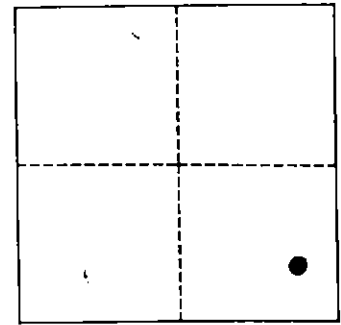
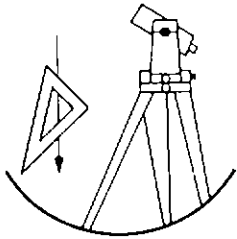

VERTICAL CONTROL

NGVD 29 Elevation: 485.623 FEET NAVD 88 Elevation: 149.085 METERS
 NGS Line # L025035 USGS LINE # _____ OSHD Line # _____ FILE # _____
 NGVD 29 Precision: 2ND ORDER Agency: DCSO Proj: 2007 Date: 1990
 NAVD 88 Precision: 1ST ORDER Agency: NGS Proj: _____ Date: 1988

HORIZONTAL CONTROL

O.C.S. 27 Y(Northing): _____ O.C.S. 83 Y(Northing): _____
 (South Zone) X(Easting): _____ (South Zone) X(Easting): _____
 Precision: _____ Agency: _____ Proj: _____ Date: _____
 Approx. O.C.S. 27 Geographic Position: Latitude: 43°21'04" Longitude: 123°19'36"
 Approx. O.C.S. 83 Geographic Position: Latitude: _____ Longitude: _____

Found: A 9/16 inch diameter stainless steel rod set under a 6 - 5/8 inch diameter aluminum collar and access cover set in concrete and flush with ground. Rim of access cover collar is stamped "Z 739 1987".

To reach: From the intersection of Comstock Rd. (Co. Rd. #154) and Old Hwy 99 (Co. Rd. #388) at I-5 exit 135 proceed southerly along Old Hwy 99 (Co. Rd. #388) approx. 1.25 miles to monument on left.

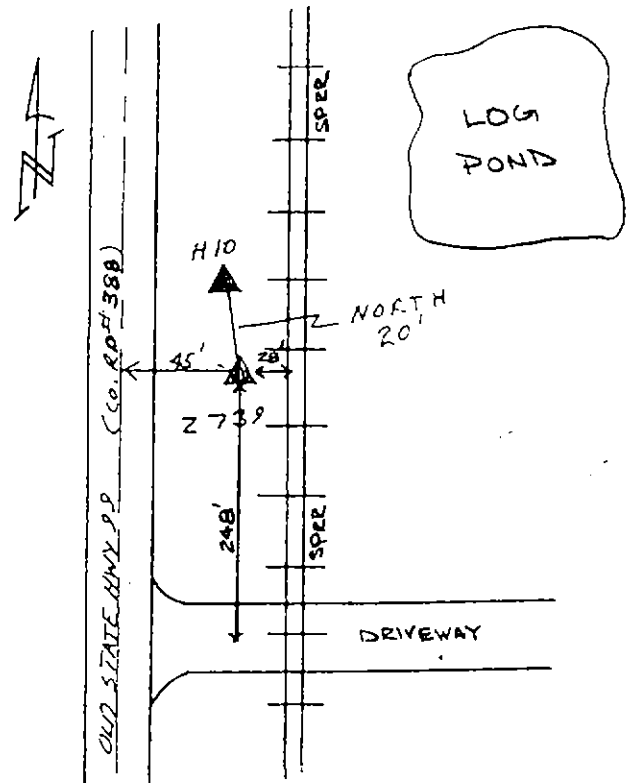

Note: For further information contact the Douglas County Surveyors Office, Room 205 Douglas County Justice Building, Roseburg, OR 97470. Phone 440-4272. Douglas County Residents outside Roseburg calling area, dial toll free 1-800-477-0991.