

OFFICE OF THE
DOUGLAS COUNTY SURVEYOR

Station: Z 496
 Date Set: 1942
 Set By (Agency): USC&GS
 DCSO Designation: Z-007
 Date Recovered: 8-93
 Recovered By: RWS SJF
 Date Recovered: _____
 Recovered By: _____
 Date Recovered: _____
 Recovered By: _____

T25W R5W Sec. 8

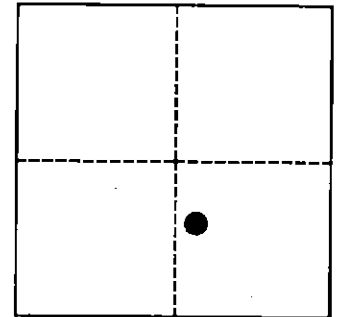
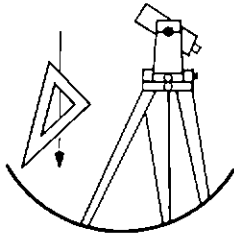

VERTICAL CONTROL

NGVD 29 Elevation: 517.461 FEET NAVD 88 Elevation: 158.792 METERS
 NGS Line # L25035 USGS LINE # _____ OSHD Line # _____ FILE # _____
 Precision: 1ST ORDER Agency: CGS Proj: _____ Date: 1988

HORIZONTAL CONTROL

O.C.S. 27 Y(Northing): _____ O.C.S. 83 Y(Northing): _____
 (South Zone) X(Easting): _____ (South Zone) X(Easting): _____
 Precision: _____ Agency: _____ Proj: _____ Date: _____
 Approx. O.C.S. 27 Geographic Position: Latitude: 43°24'25" Longitude: 123°18'47"
 Approx. O.C.S. 83 Geographic Position: Latitude: _____ Longitude: _____

Found: A 3 1/2 inch diameter disk stamped "Z 496 1942" set flush in a concrete head wall.

To reach: Go to the intersections of Old Hwy 99N (Co. Rd. #388), Union Gap Loop Rd. (Co. Rd. #256) and Three Forks Ln. in T25S R5W Sec8. Monument is northwest of intersection and 9.4 feet easterly from east railroad rail.

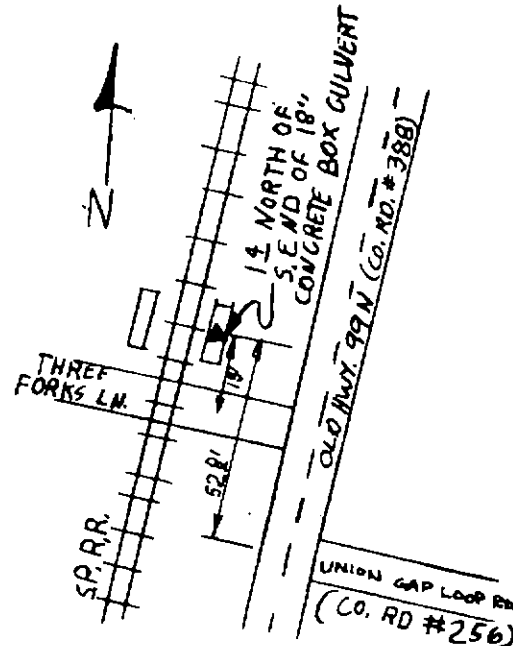

Note: For further information contact the Douglas County Surveyors Office, Room 205 Douglas County Justice Building, Roseburg, OR 97470. Phone 440-4272. Douglas County Residents outside Roseburg calling area, dial toll free 1-800-477-0991.