

OFFICE OF THE

DOUGLAS COUNTY SURVEYOR

S-130
STEARNS

25S 5W 7

NAD 83 647293.41 4165345.72
43°24'27" 123°20'43"

T 25 S, R 5 W, Sec. 7

Station: STEARNS

Set By (Agency): DCSO

Date: 1980

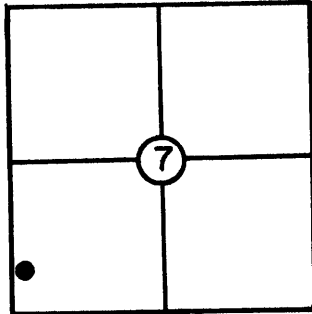

VERTICAL CONTROL

NGVD 29
Elevation: ~~401.140~~ NGS(USC&GS) Line # _____ USGS Line # _____
(Calapooya)

Order
Of Precision ~~4th~~ Agency: ~~DCSO~~ Proj. #: ~~2006~~ Date: ~~1981~~

HORIZONTAL CONTROL

NAD 27
Oregon State Plane Coordinates: Y(Northing) 647,327.98 X(Easting) 1,244,386.54
(South Zone)

(Calapooya)
Order
Of Precision 1/25,000 Agency: DCSO Proj. #: 2006 Date: 1981

Approximate Geographic Position: Latitude= 43° 24' 28" Longitude= 123° 20' 39"

DESCRIPTION: Station is a standard DCSO
brass cap set in a conc. filled 6"x42" bell-
tile buried 34" in the ground. 27 ft. from
centerline of Stearns Ln. and 24.6 ft. W'stly
of private access road. Tele. pole bears
N86°W, 94.6 ft.(numbered 11) and tele. pole
bears S60°W, 94.7 ft.(numbered 11A).

TO REACH: From the underpass of Stearns
Rd & I-5, proceed Southwesterly 1.1 mi.
to station on S'ly side of road.
VICINITY: 2.5 mi. SW of Oakland.

SKETCH

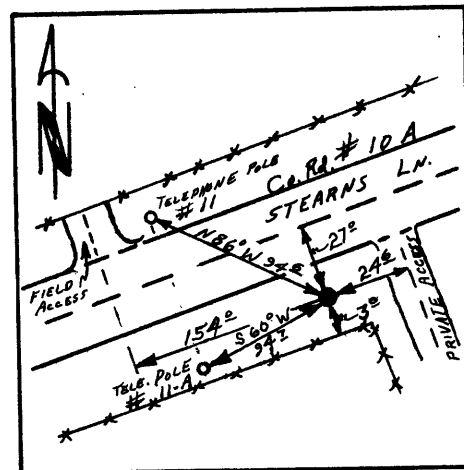

NOTE: For Possible Further Information On This Station, Please Contact The Douglas County Surveyors Office, Rm. 205 Douglas County Justice Bldg., Roseburg, OR. 97470 Phone 672-3311 Ext. 272.. Douglas County residents outside the Roseburg calling area dial toll free 1-800-452-0991.