

OFFICE OF THE
DOUGLAS COUNTY SURVEYOR

Station: MEDLEY T 24 S, R 5 W , Sec 25
 Set By (Agency): DCSO
 Date Set: 1980
 Recovered By RWS, SJE
 Date Recovered 9/3/87
 Recovered By _____
 Date Recovered _____
 Recovered By _____
 Date Recovered _____

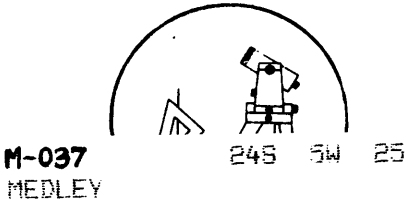
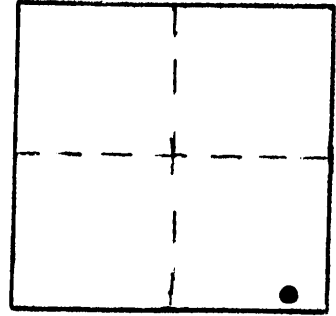

NAD 660974.83 4195879.06
 83 43°26'52" 123°13'56"

VERTICAL CONTROL NGVD 29

Elevation: 487.361 NGS Line # _____ USGS Line # _____ OSHD Line # _____
 Precision: 2nd Agency: DCSO Proj. # 2006 Date: 1981

HORIZONTAL CONTROL NAD 27

South Zone State Plane Coordinates: Y(Northing) 661,009.43 X(Easting) 1,274,919.59
 Precision: 1/25,000 Agency: DCSO Proj. # 2006 Date: 1981
 Approximate Geographic Position: Latitude 43°26'53" Longitude 123°13'51"

DESCRIPTION and TO REACH

SKETCH

A DCSO disk stamped "MEDLEY 1980" set in a
 8 in. dia. concrete filled belltile protruding
 7 in. above ground.

TO REACH:

Go to the intersection of Elkhead Rd.
 (Co.Rd.#50) and Driver Valley Rd. (Co.Rd.#22)
 in T24S,R5W,Sec.25, monument is southeast of
 intersection.

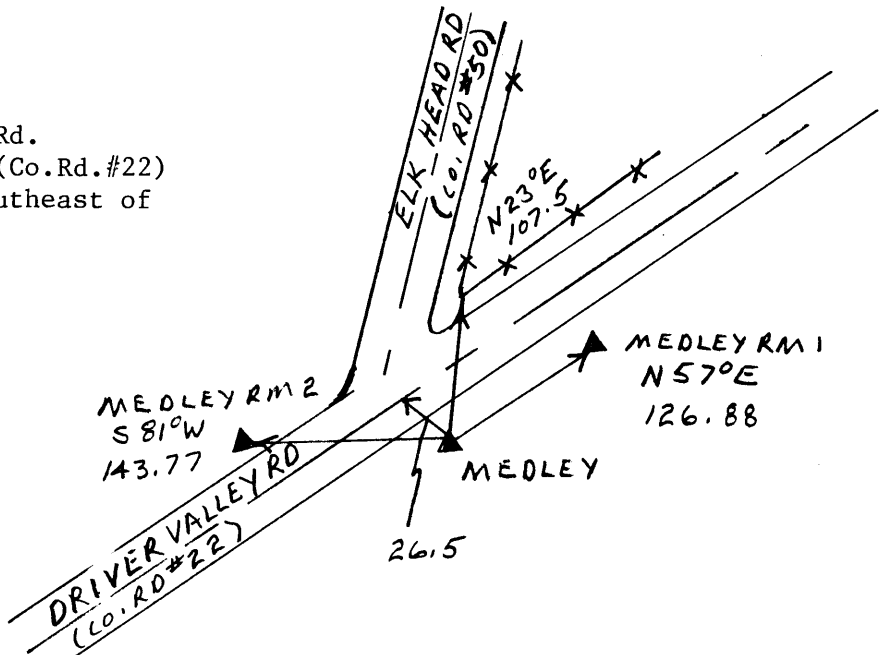

Reference Marks:

A DCSO disk stamped "MEDLEY RM1 1980"
 bears N 59°18'35" E, 126.88 ft.(grid).

A DCSO disk stamped "MEDLEY RM2 1980"
 bears S 83°06'03" W, 143.77 ft. (grid).

Note: For further information, contact the Douglas County Surveyor's Office, Room 205
 Douglas County Justice Building, Roseburg, OR 97470. Phone 440-4278. Douglas
 County residents outside the Roseburg calling area, dial toll free 1-800-452-0991.